

## 1041 N. BRYANT

## EDMOND, OK 73034



### PROPERTY DESCRIPTION

1041 N. Bryant is conveniently located in the Kingston Office Park in the heart of Edmond. Tenants will find that everything they need is just a short drive away from this space. This suite provides a unique opportunity for tenants in the market for rent ready space. Nearby neighbors include: Kickingbird Golf Club, Target, Walgreens, Chick Fil-A and more.

### PROPERTY HIGHLIGHTS

- Newly built out Office Space
- Flexible layout, could be used as four private offices, or three private offices and a conference room.
- High-end finishes Private restrooms within the suite
- Free surface parking
- Suite includes a built-out break area

### OFFERING SUMMARY

<b>Lease Rate:</b>	\$17.00 SF/yr (Full Service)
<b>Building Size:</b>	3,000 SF
<b>Available SF:</b>	1,250 SF

#### IAN SELF

iself@priceedwards.com  
O: 405.239.1271

#### TRE DUPUY

tdupuy@priceedwards.com  
O: 405.239.1210 C: 405.412.3810

1041 N. BRYANT

EDMOND, OK 73034



**IAN SELF**

iself@priceedwards.com  
O: 405.239.1271

**TRE DUPUY**

tdupuy@priceedwards.com  
O: 405.239.1210 C: 405.412.3810

1041 N. BRYANT

EDMOND, OK 73034

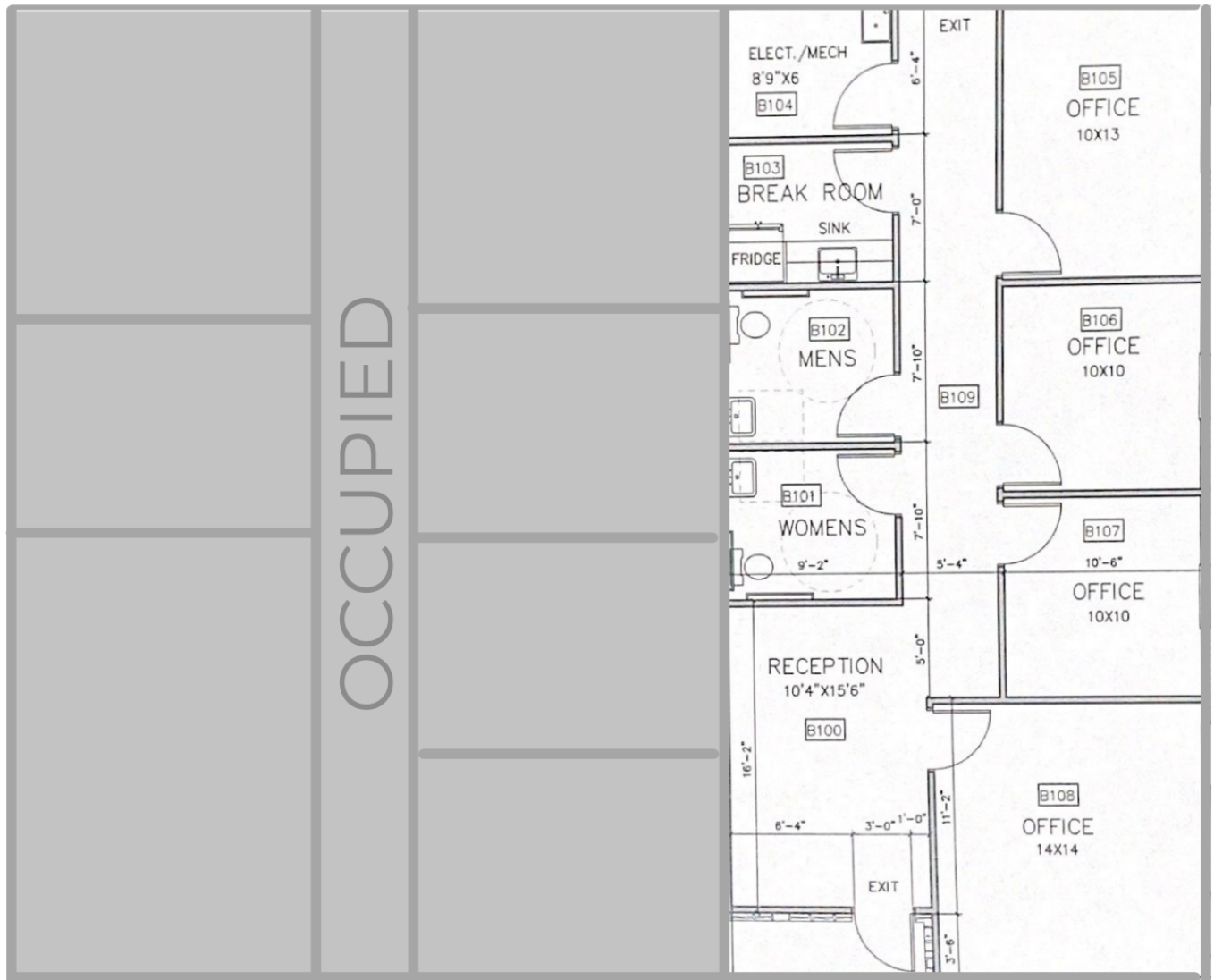

**IAN SELF**

iself@priceedwards.com  
O: 405.239.1271

**TRE DUPUY**

tdupuy@priceedwards.com  
O: 405.239.1210 C: 405.412.3810

## 1041 N. BRYANT

EDMOND, OK 73034

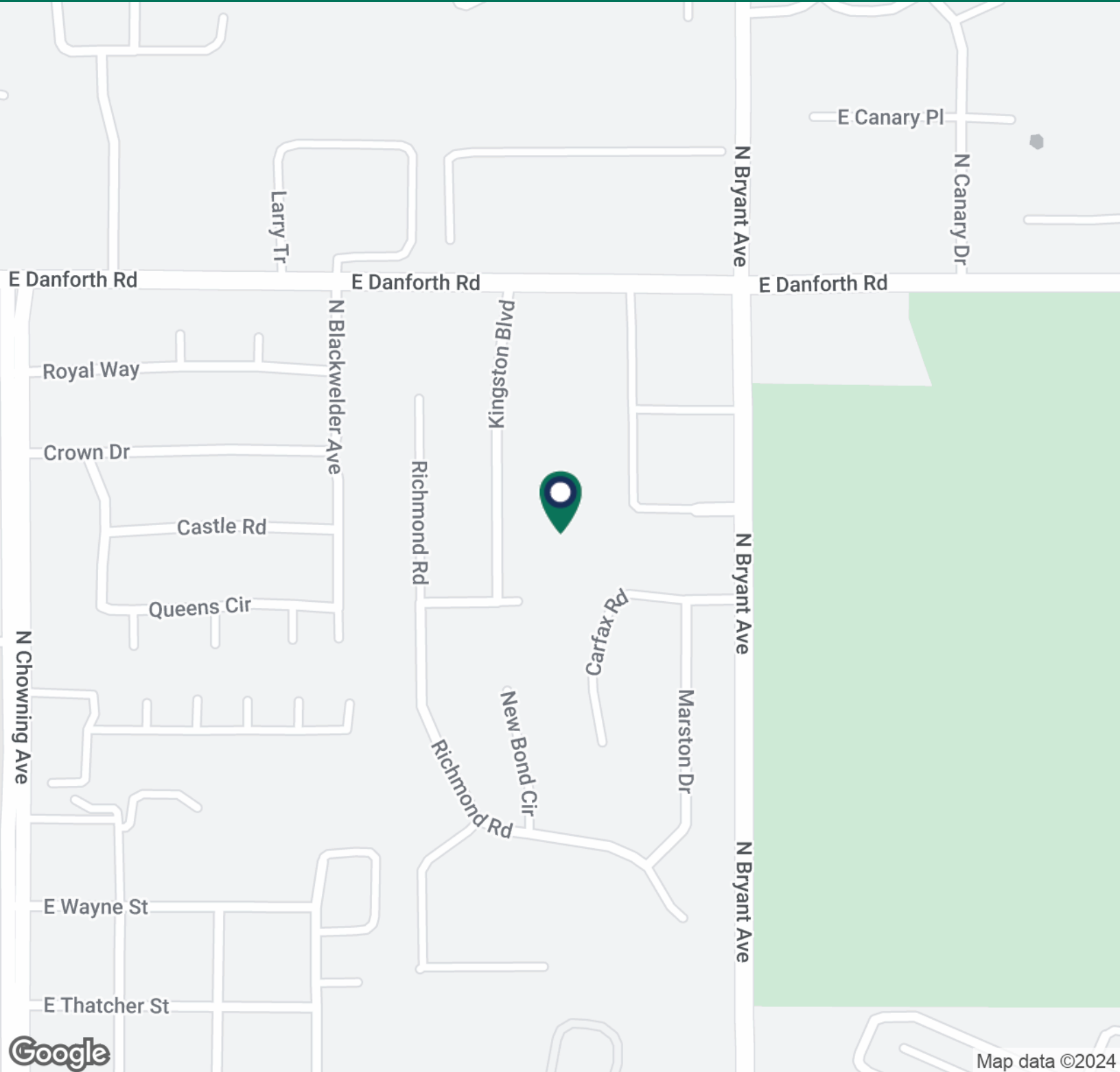

### IAN SELF

iself@priceedwards.com  
O: 405.239.1271

### TRE DUPUY

tdupuy@priceedwards.com  
O: 405.239.1210 C: 405.412.3810