

36th & Portland Center

3601 N Portland Ave, Oklahoma City, OK 73112



RETAIL SPACE NOW AVAILABLE

Available SF:	1,012 SF
Lease Rate:	\$750 per month
Lot Size:	0.97 Acres
Building Size:	12,800 SF
Year Built:	1973
Sub Market:	Northwest

Well located strip center on the southwest corner of NW 36th St & N Portland Ave, just west of I-44.

Tenants include Richard Murphy CPA, Dreamland Sleep Center, Impressions Salon, Professional TV Repair and others.

Nearby tenants include McDonalds, Carl's Jr, AAA Insurance & Travel and SuperCuts.

081816

FOR MORE INFORMATION, CONTACT

Susan Brinkley
sbrinkley@priceedwards.com
405.239.1244
210 Park Ave, Suite 700
Oklahoma City, OK 73102
www.priceedwards.com

36th & Portland Center

3601 N Portland Ave, Oklahoma City, OK 73112

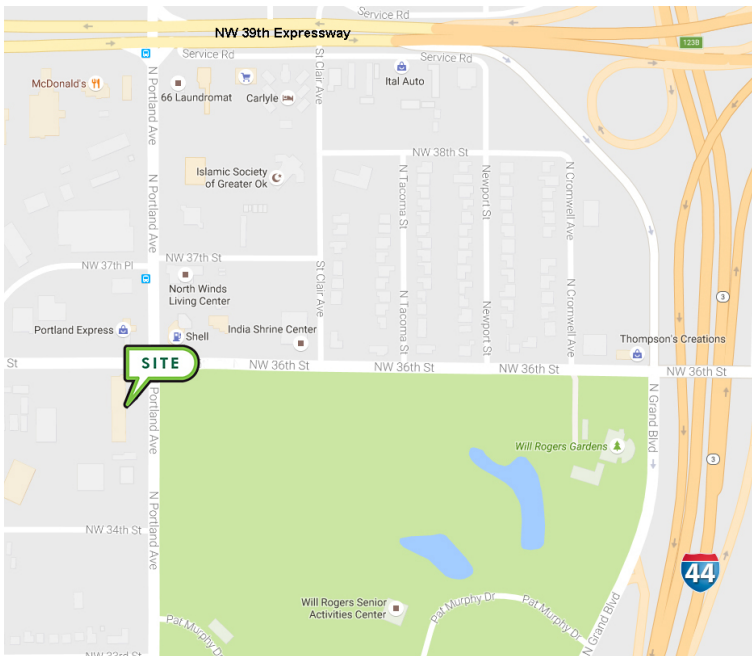

DEMOGRAPHICS (per 2010 Census; 5 Miles Radius)

Total Population	227,531
Population Density	227,531
Median Age	35.1
Median Age (Male)	34.5
Median Age (Female)	35.7
Total Households	95,651
# of Persons Per HH	2.4
Average HH Income	\$56,129
Average House Value	\$159,795

TRAFFIC COUNTS (per ACOG)

N Portland	north	11,400
N Portland	south	12,302
NW 36th	east	14,812
NW 36th	west	14,777

The information above has been obtained from sources believed reliable. While we do not doubt its accuracy, we have not verified it and make no guarantee, warranty, or representation about it. You and your legal and technical advisors should conduct a careful, independent investigation of the property to determine to your satisfaction to the suitability of the property for your needs.