

# 8TH STREET MARKET

3 NE 8th Street, Oklahoma City, OK 73104



## OFFERING SUMMARY

Available SF:	800 - 5,060 SF
Lease Rate:	\$23.00 SF/yr (NNN)
Lot Size:	0.65 Acres
Year Built:	1948
Building Size:	19,645
Renovated:	2018
Market/Submarket:	OKC/Midtown Automobile Alley  112118

## PROPERTY OVERVIEW

Amazing indoor market retail space in downtown Oklahoma City's Auto Alley District.

## PROPERTY HIGHLIGHTS

- 5,060 SF Available - Retail
- 650 SF space - outdoor patio available with endcap
- On-Site Parking
- Walkable district
- Anchored by Prairie Brewing Company
- Easy Access to the new 8th & Broadway Streetcar Stop
- Over 700 apartment and condos within walking distance
- Social Common Area
- Current Tenants: Magasin Table, Yoga Studio, Mariposa Coffee & Key Construction
- Population in excess of 188,000 people within 5 mile radius

## GIRMA MOANING

Retail Investment Specialist  
gmoaning@priceedwards.com  
405.843.7474  
210 Park Ave, Suite 700, Oklahoma City, OK 73102  
priceedwards.com

# 8TH STREET MARKET

3 NE 8th St, Oklahoma City, OK 73104

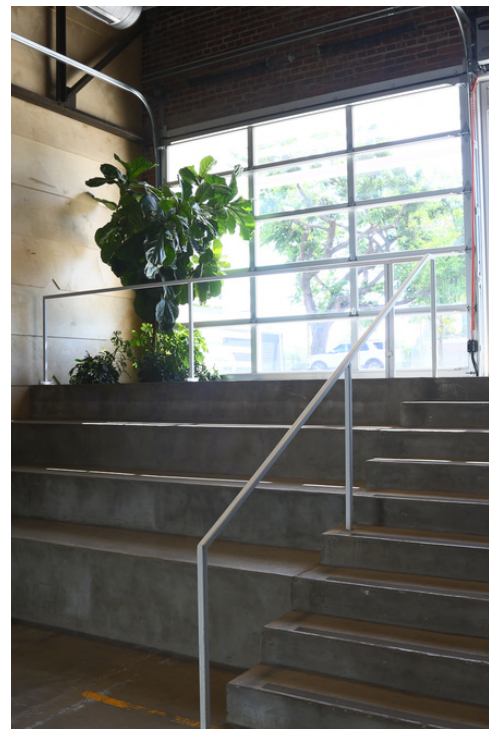

## GIRMA MOANING

Retail Investment Specialist  
gmoaning@priceedwards.com

405.843.7474

210 Park Ave, Suite 700, Oklahoma City, OK 73102

priceedwards.com

The information above has been obtained from sources believe reliable. While we do not doubt its accuracy, we have not verified it and make no guarantee, warranty, or representation about it. You and your legal and technical advisors should conduct a careful, independent investigation of the property to determine to your satisfaction to the suitability of the property for your needs.

# 8TH STREET MARKET

3 NE 8th St, Oklahoma City, OK 73104 - Floor Plan

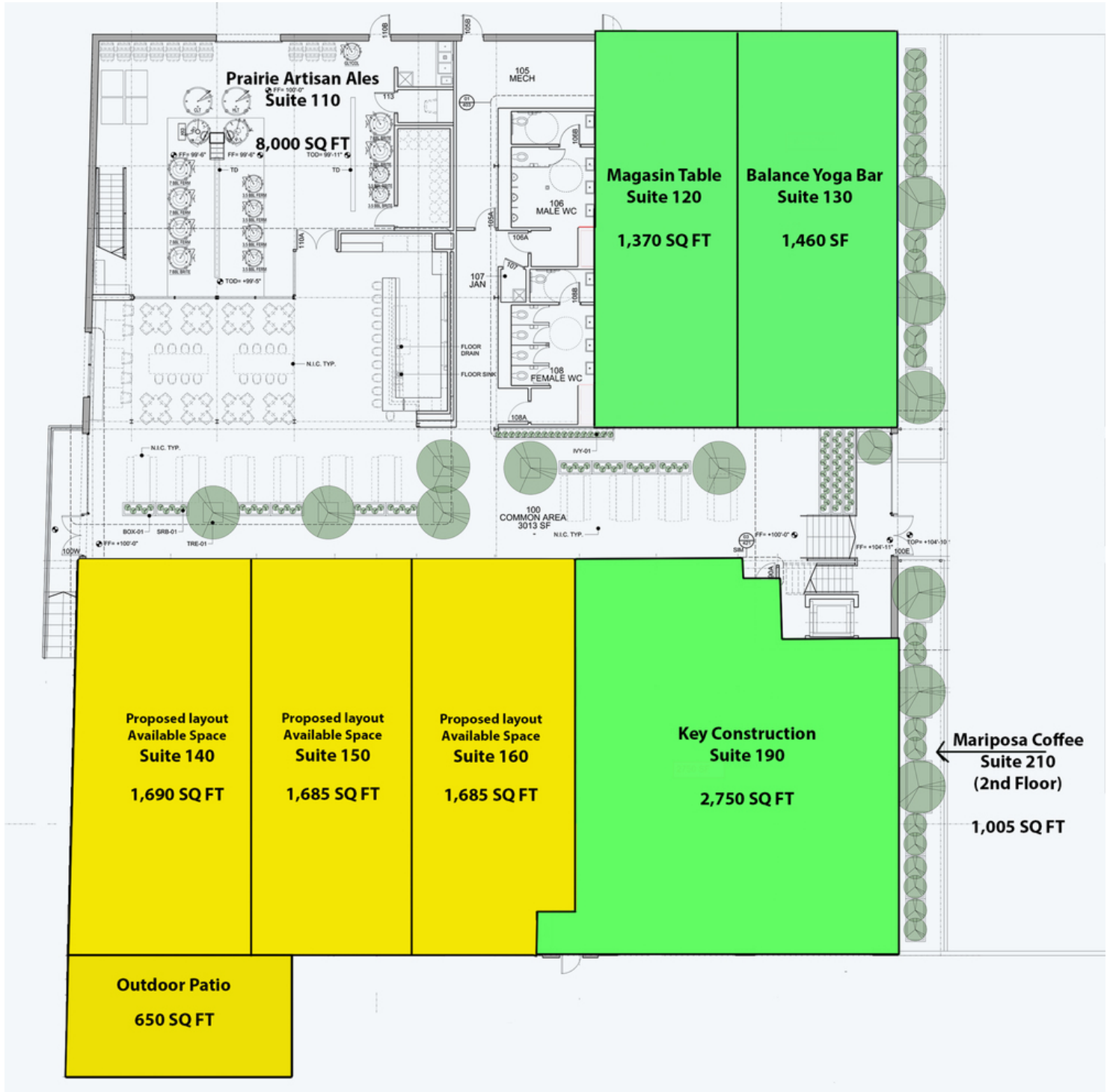

## GIRMA MOANING

Retail Investment Specialist  
gmoaning@pricedwards.com

405.843.7474

210 Park Ave, Suite 700, Oklahoma City, OK 73102

pricedwards.com

# 8TH STREET MARKET

3 NE 8th St, Oklahoma City, OK 73104 - Retailer Map



## GIRMA MOANING

Retail Investment Specialist  
gmoaning@priceedwards.com

405.843.7474

210 Park Ave, Suite 700, Oklahoma City, OK 73102

priceedwards.com