

# Retail in The Steelyard

505 East Sheridan, Oklahoma City, OK, 73104



ELEVATION - SHERIDAN AVENUE

## RETAIL SPACE AVAILABLE IN THE STEELYARD

<b>Available SF:</b>	17,250 SF
<b>Lease Rate:</b>	Negotiable
<b>Minimum Divisible</b>	1,200 SF
<b>Market:</b>	Downtown
<b>Sub Market:</b>	Bricktown
<b>Cross Streets:</b>	Charlie Christian Avenue & Sheridan Avenue

Construction is well underway on The Steelyard, Bricktown's newest mixed-use development. Includes 250 units of apartments, two hotels and over 17,000 square feet of retail.

13,000 square feet of retail space faces the new Criterion music venue and Sheridan Avenue, a well-traveled entrance to Bricktown.

Pre-leasing now — completion scheduled for early 2017.

052416

### FOR MORE INFORMATION, CONTACT

Allison Barta Bailey  
abailey@priceedwards.com  
405.239.1245  
210 Park Ave, Suite 1000  
Oklahoma City, OK 73102  
www.priceedwards.com

# Retail in The Steelyard

505 East Sheridan, Oklahoma City, OK, 73104



ELEVATION - SHERIDAN AVENUE



## DEMOGRAPHICS (per 2016 Census; 20 Mile Radius)

Total Population	1,143,514
Median Age (Male)	33.6
Median Age	34.7
Median Age (Female)	35.9
Total Households	457,034
# of Persons Per HH	2.45
Average HH Income	\$73,563
Average House Value	\$136,109

# Retail in The Steelyard

505 East Sheridan, Oklahoma City, OK, 73104

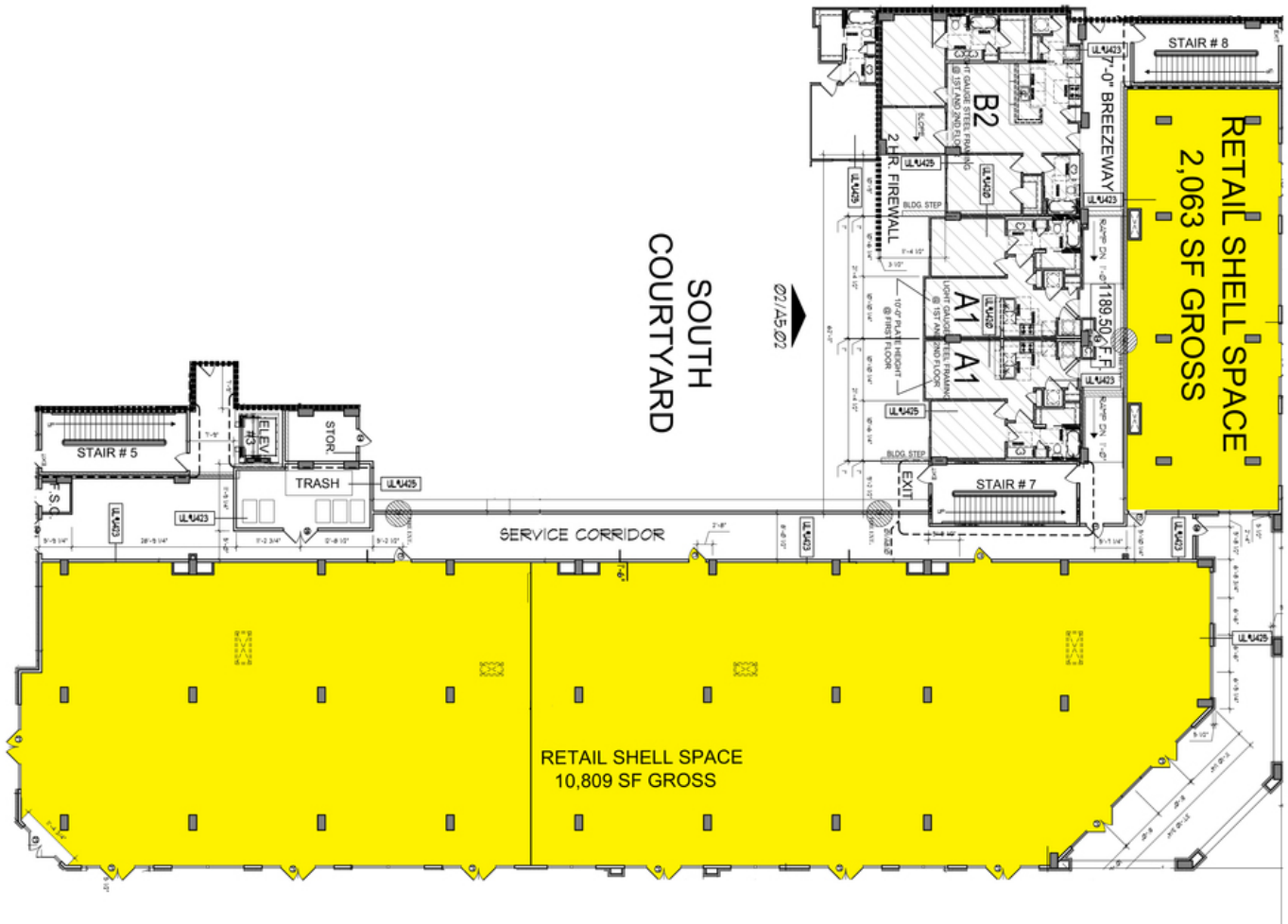

# The Steelyard

505 East Sheridan Oklahoma City, OK 73104

