

# SWANSON'S BUILDING - SUITE 103

1004 N. Hudson Oklahoma City, OK 73103



## OFFICE / RETAIL SPACE NOW AVAILABLE

<b>Available SF:</b>	1,748 SF
<b>Lease Rate:</b>	\$23.50 SF/yr (NNN)
<b>Location:</b>	Located on the NE corner of 9th & Hudson in the Swanson's Building
<b>Building Size:</b>	14,107 SF
<b>Market:</b>	Downtown - Midtown

## ABOUT SUITE 103

Located in view of a new Streetcar stop, this is a great small office or retail location. This suite faces the Barrio's patio and is in line with 405 Yoga, Baker Street Escapes and Hall's Pizza Kitchen.

Suite has access to the building's common area restrooms and sign marquee on Hudson Avenue. A new heat & air mechanical unit, industrial ceiling, concrete floor and back door to the north alley were installed in the building's recent renovation. Exposed original brick is visible on both the north and south walls of the suite.

## ALLISON BARTA BAILEY

Urban Leasing  
abailey@priceedwards.com  
405.239.1245  
210 Park Ave, Suite 700, Oklahoma City, OK 73102  
priceedwards.com

# SWANSON'S BUILDING

Building Floor Plan

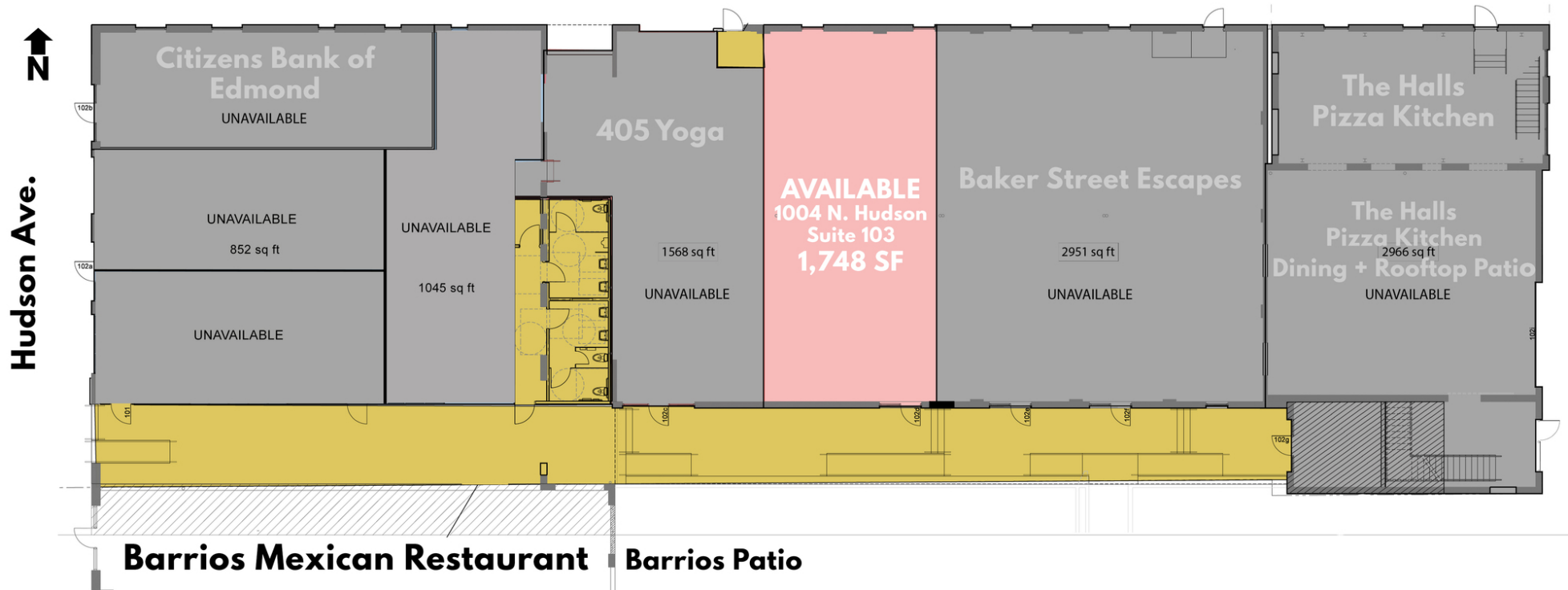

ALLISON BARTA BAILEY

Urban Leasing  
abailey@priceedwards.com  
405.239.1245  
210 Park Ave, Suite 700, Oklahoma City, OK 73102  
priceedwards.com

# SWANSON'S BUILDING

Image of Swanson's facing Hudson.



## ALLISON BARTA BAILEY

Urban Leasing  
abailey@pricedwards.com  
405.239.1245  
210 Park Ave, Suite 700, Oklahoma City, OK 73102  
pricedwards.com



# SWANSON'S BUILDING

View from Suite 103 - Barrio's Patio



## ALLISON BARTA BAILEY

Urban Leasing  
abailey@priceedwards.com  
405.239.1245  
210 Park Ave, Suite 700, Oklahoma City, OK 73102  
priceedwards.com