



LEASE AVAILABILITY

Available SF: ±5,332 RSF
±3,556 RSF
±831 RSF

Lease Rate: \$16.50 SF/yr with
\$0.50/SF annual
increase

Lease Type: Full Service with
Landlord paying
utilities & janitorial

3 yr minimum term

Building Size: 14,980 SF

Submarket: Midtown

PROPERTY OVERVIEW

- Mixed offices with 6 built-in cubicles
- Floor to ceiling windows
- Large reception area
- Full Kitchen
- Portico
- Exterior signage available facing Robinson Ave.
- 7 on-site free parking spaces + more across the street
- Access to work out facility

LOCATION OVERVIEW

Approximately 12 foot ceilings throughout the building
New roof
Portico entryways
Half mile to Interstate 235
Less than a mile to the courthouse
1 mile to Chesapeake Energy Arena

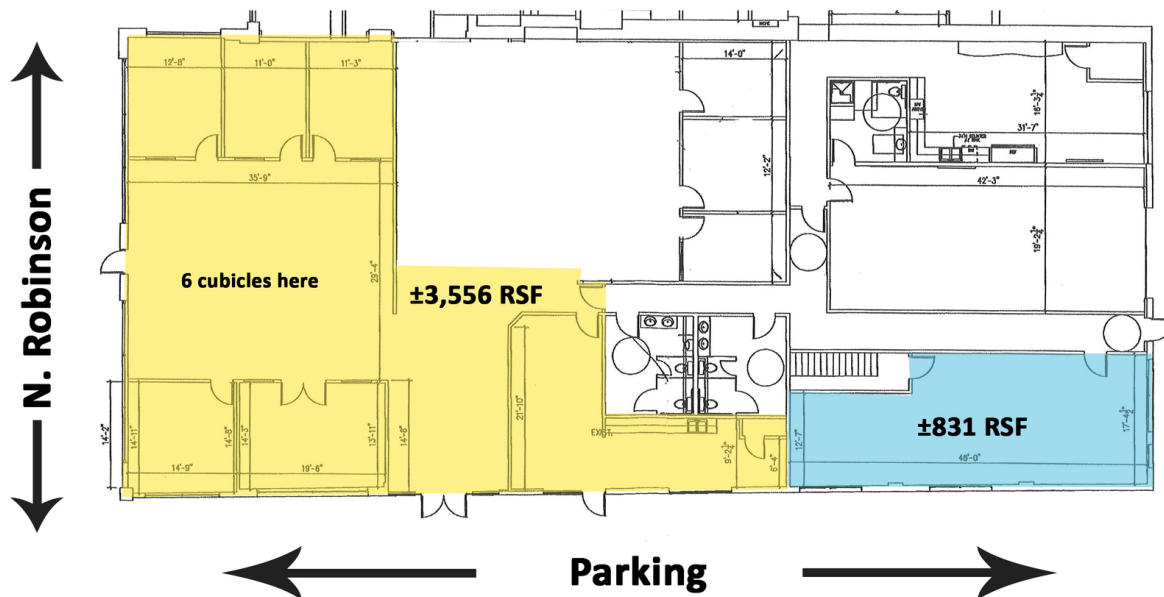
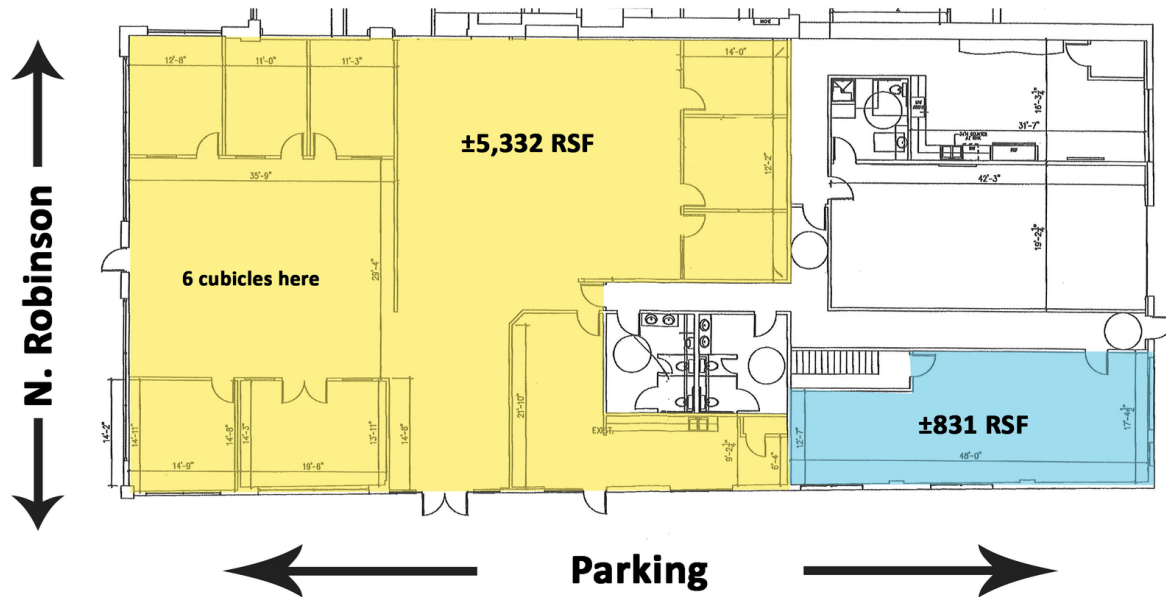

1220 N Robinson Avenue

Oklahoma City, OK 73103



TOM FIELDS
405.239.1205
tfields@priceedwards.com

The information above has been obtained from sources believe reliable. While we do not doubt its accuracy, we have not verified it and make no guarantee, warranty, or representation about it. You and your legal and technical advisors should conduct a careful, independent investigation of the property to determine to your satisfaction to the suitability of the property for your needs.