



## OFFERING SUMMARY

Lease Rate:	\$17.00 SF/yr (NNN) 3% annual increases
Building Size:	± 6,020 SF
Lot Size:	1.27 Acres
Year Built:	1997
Parking:	70 Stalls (7.59/1,000 SF)
Zoning:	E-1

## LOCATION OVERVIEW

Located 2 miles west of I-35, on the south side of 2nd Street between Coltrane Road and Bryant Avenue. 1 mile east of University of Central Oklahoma and 1/2 mile from OU-Edmond Medical Center.

## PROPERTY HIGHLIGHTS

- +/- 160' of frontage on 2nd Street (with 2 curb cuts)
- Excellent signage opportunities
- 27,000 daily traffic count
- 70 parking spots
- Outdoor, covered patio on east side (shaded)
- Drive-thru capability

**TOM FIELDS**  
405.239.1205  
tfields@priceedwards.com  
priceedwards.com

**EV ERNST**  
405.843.7474  
eernst@priceedwards.com  
priceedwards.com



# Office/Retail Space For Lease

2080 E 2nd St., Edmond, OK 73034

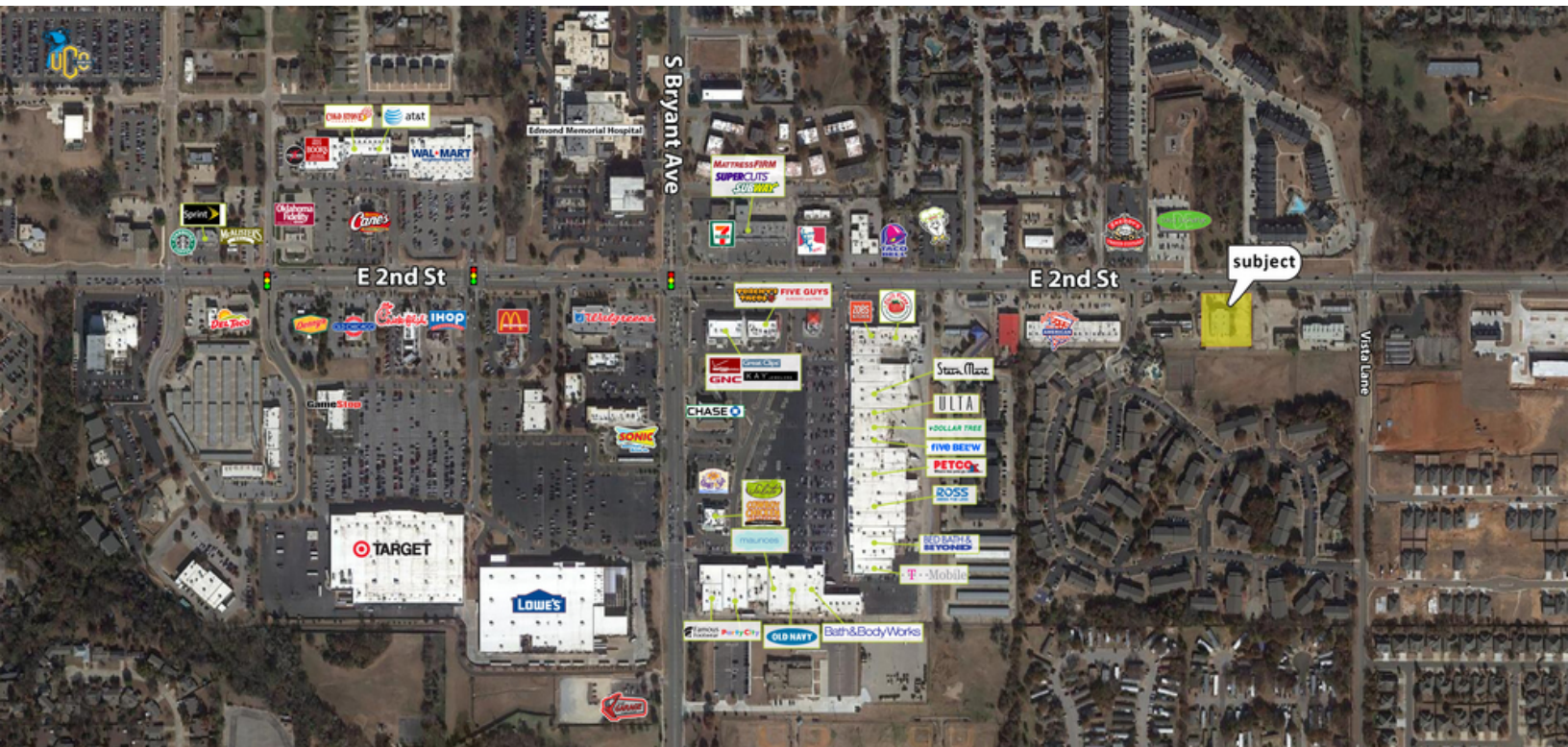
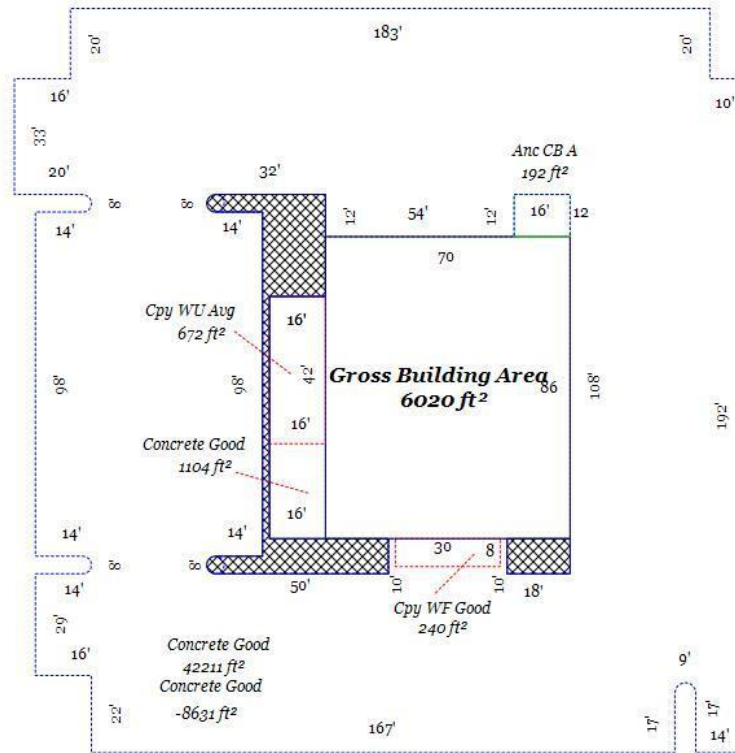

**TOM FIELDS**  
405.239.1205  
tfields@priceedwards.com  
priceedwards.com

**EV ERNST**  
405.843.7474  
ernst@priceedwards.com  
priceedwards.com