



OFFERING SUMMARY

Lease Rate:	\$22.00 SF/yr (NNN)
Building Size:	7,204 SF
Available SF:	1,500 - 7,204 SF

PROPERTY OVERVIEW

Newly remodeled building with expansive ceiling and architectural details. Ready for tenant build out with available tenant improvement allowance.

Location is suitable for office or retail with adjacent parking and sign opportunities.

PROPERTY HIGHLIGHTS

- Natural Light
- Adjacent Parking
- Sign opportunity
- Walking distance to downtown residential
- Architectural details like historical brick and steel truss ceiling

ALLISON BARTA BAILEY
405.239.1245
abailey@priceedwards.com
priceedwards.com

IAN SELF
405.239.1271
iself@priceedwards.com
priceedwards.com

**PRICE
EDWARDS**
AND COMPANY

23 NE 6th Street
Automobile Alley, Oklahoma City, OK 73104



ALLISON BARTA BAILEY
405.239.1245
abailey@pricedwards.com
pricedwards.com

IAN SELF
405.239.1271
iself@pricedwards.com
pricedwards.com

The information contained herein is from sources deemed reliable. No representation is made to the accuracy herein. Photos herein are the property of their respective owners, and use of them without express written consent of the owner is prohibited.

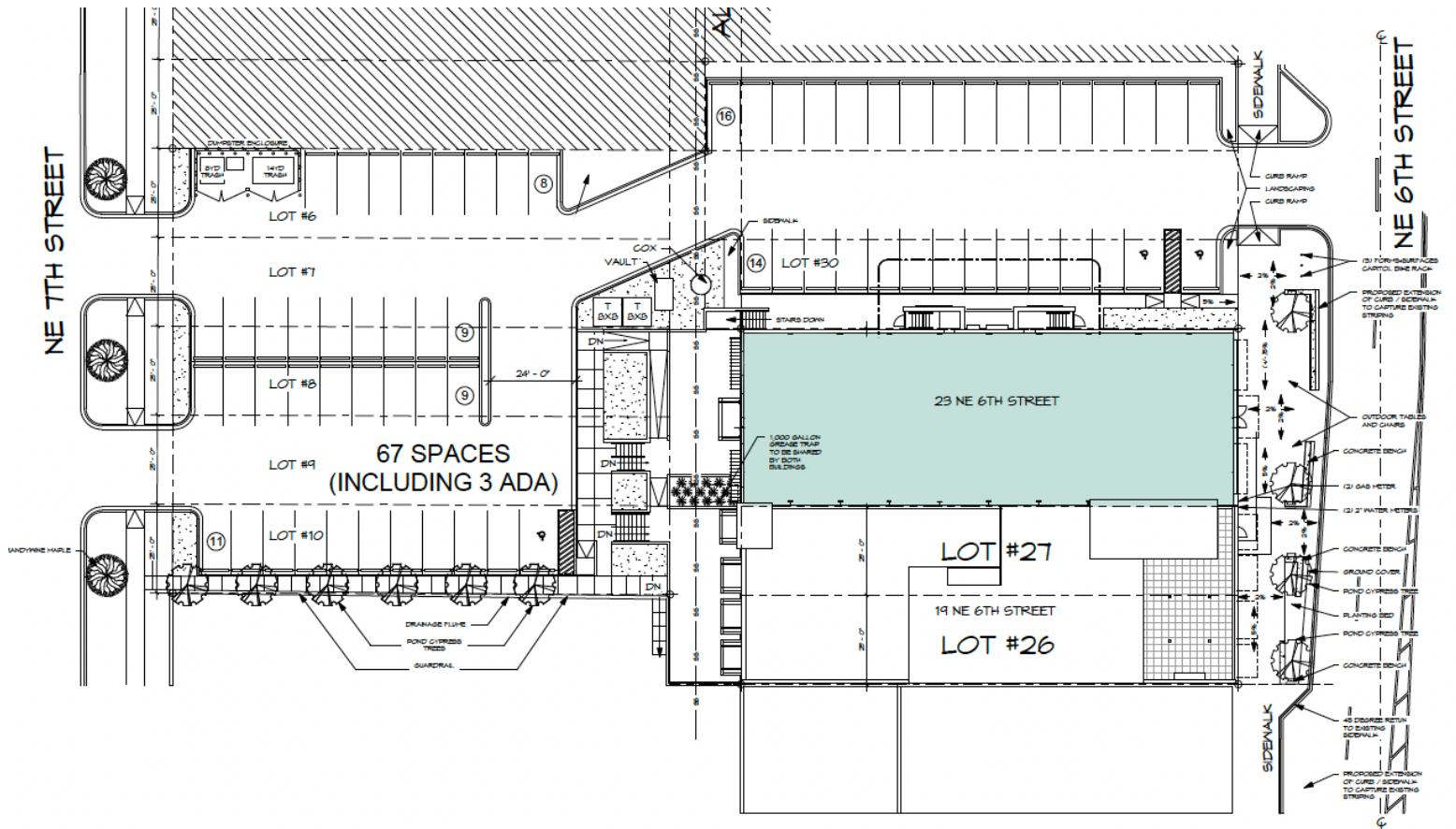

A Architectural Site Plan
1" = 20'-0"

ALLISON BARTA BAILEY
405.239.1245
abailey@priceedwards.com
priceedwards.com

IAN SELF
405.239.1271
iself@priceedwards.com
priceedwards.com

23 NE 6th Street

Automobile Alley, Oklahoma City, OK 73104

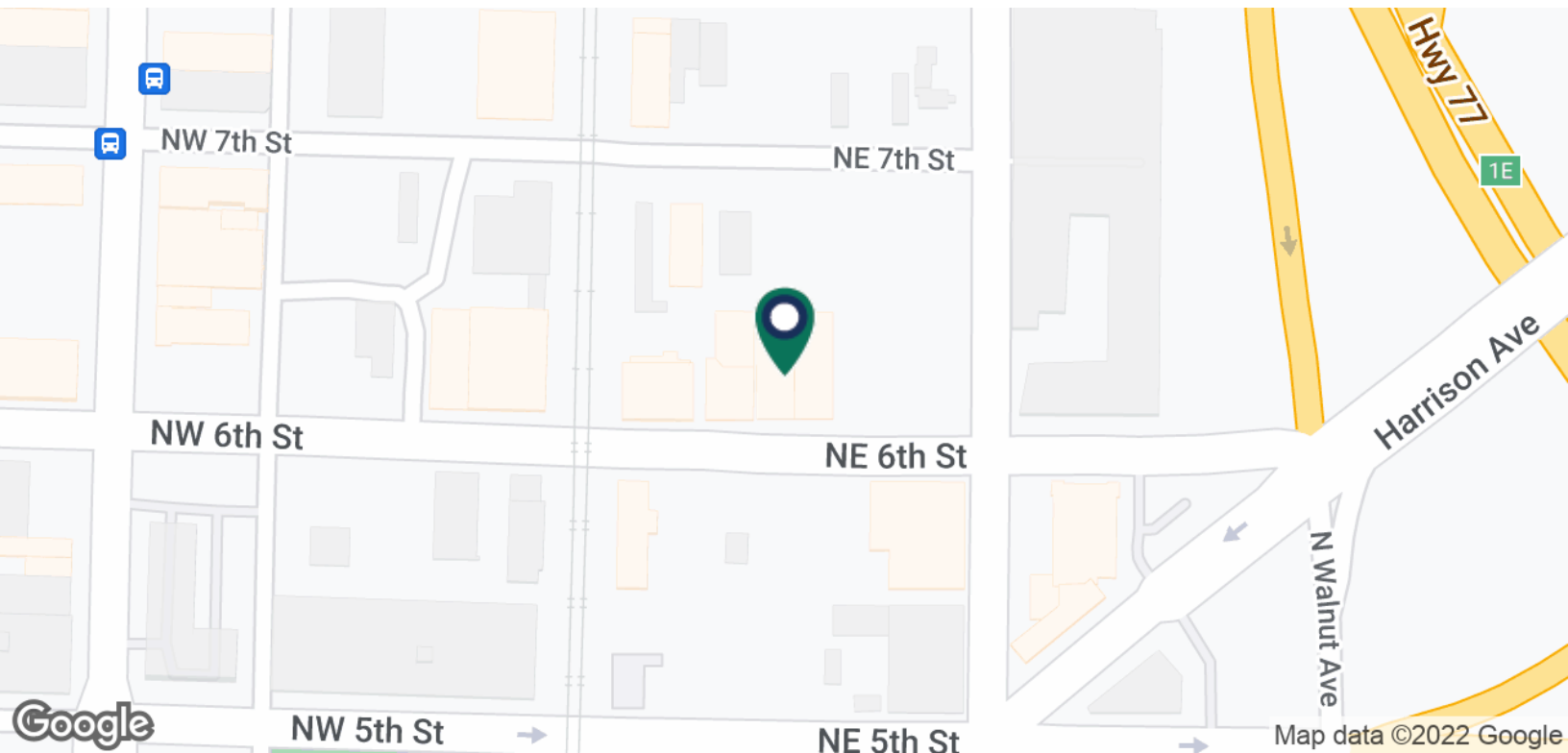
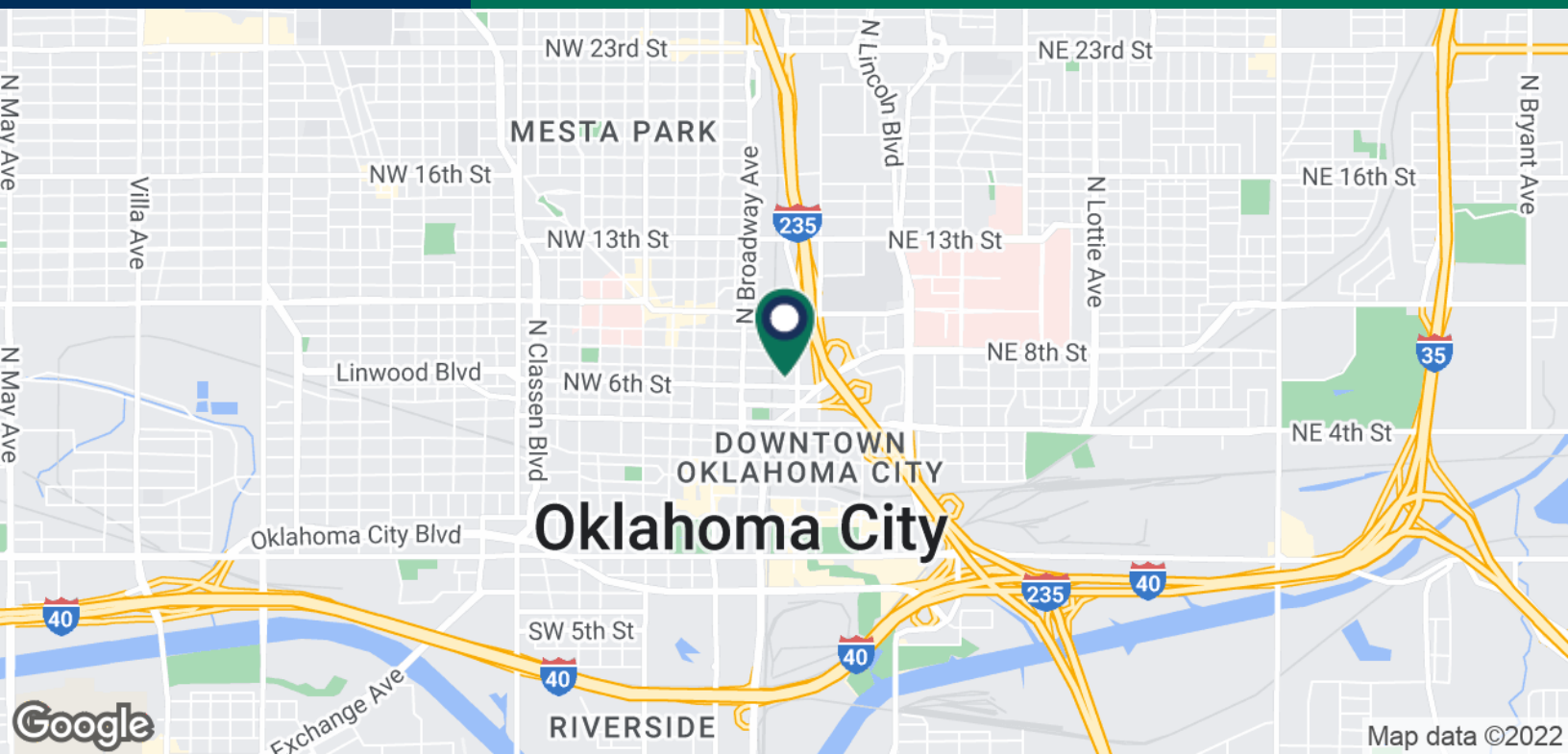

ALLISON BARTA BAILEY
405.239.1245
abailey@pricedwards.com
pricedwards.com

IAN SELF
405.239.1271
iself@pricedwards.com
pricedwards.com