

# Office Space For Lease

3441 W Memorial Rd., Oklahoma City, OK 73134



## OFFERING SUMMARY

Available SF: ± 2,514 - 3,088

Lease Rate: \$12.00 SF/yr

Tenant pays janitorial and utilities

Cross Streets: N. Portland and Memorial

## LOCATION OVERVIEW

Located on the north side of Memorial Road between Portland Ave. and May Ave. Easily accessible by Kilpatrick Turnpike.

## PROPERTY HIGHLIGHTS

- Prominent signage on Memorial Road
- Building signage on Memorial Road
- Garden style multi-tenant building
- Private entrance
- Free and ample surface parking
- Landscaped central courtyard

## TRAFFIC COUNTS

Memorial Road between Portland & May

±22,220 cars / day

**TOM FIELDS**  
405.239.1205  
tfields@priceedwards.com  
priceedwards.com



# Office Space For Lease

3441 W Memorial Rd., Oklahoma City, OK 73134

**AVAILABLE SF:  
±2,514 or 3,088 RSF**

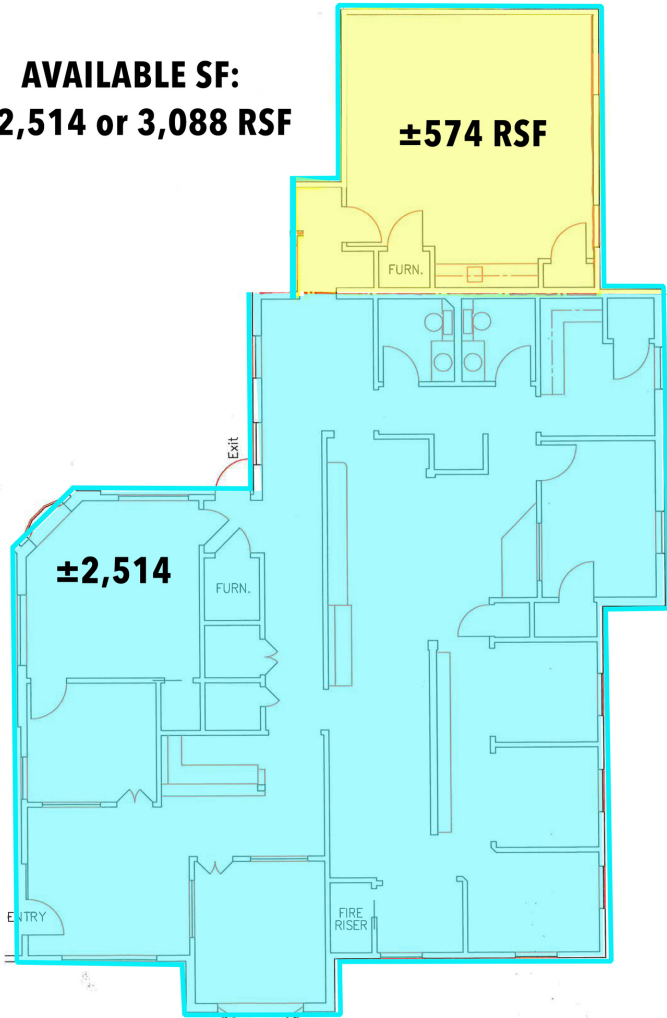

**TOM FIELDS**  
405.239.1205  
tfields@priceedwards.com  
priceedwards.com