

510 EAST MEMORIAL ROAD

OKLAHOMA CITY, OK 73114



LOCATION DESCRIPTION

Located a half of a mile west of the Broadway Extension off of Memorial Road.

PROPERTY HIGHLIGHTS

- Tenant pays utilities direct to provider plus tenants share water/sewer/trash
- This beautiful garden office property consists of 4 buildings totaling about 32,000 SF
- Abundant parking adjacent to the office
- Restaurants within walking distance
- Tenant controls heat & air conditioning
- Landlord responsible for maintenance

OFFERING SUMMARY

Building A-4: ±2,075 RSF
\$2,300 / month
+ \$100 / month CAM

Building B-1: ±2,075 RSF
\$2,300 / month
+ \$100 / month CAM

Building B-2: ±2,075 RSF
\$2,300 / month
+ \$100 / month CAM

Building B-3: ±2,075 RSF
\$2,300 / month
+ \$100 / month CAM

***All office spaces in Building B can be combined or leased individually**

TOM FIELDS

tfields@priceedwards.com
O: 405.239.1205

510 EAST MEMORIAL ROAD

OKLAHOMA CITY, OK 73114

BUILDING A

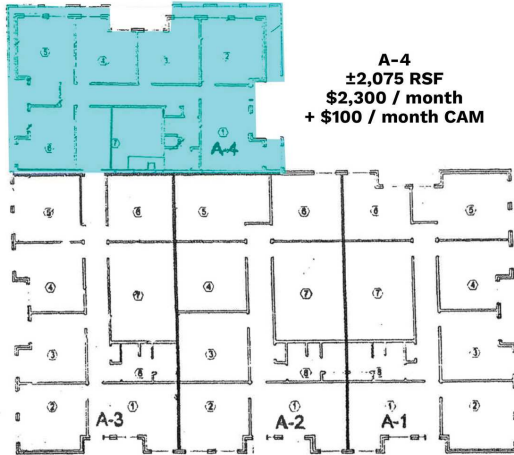

BUILDING B
CAN BE COMBINED OR LEASED INDIVIDUALLY

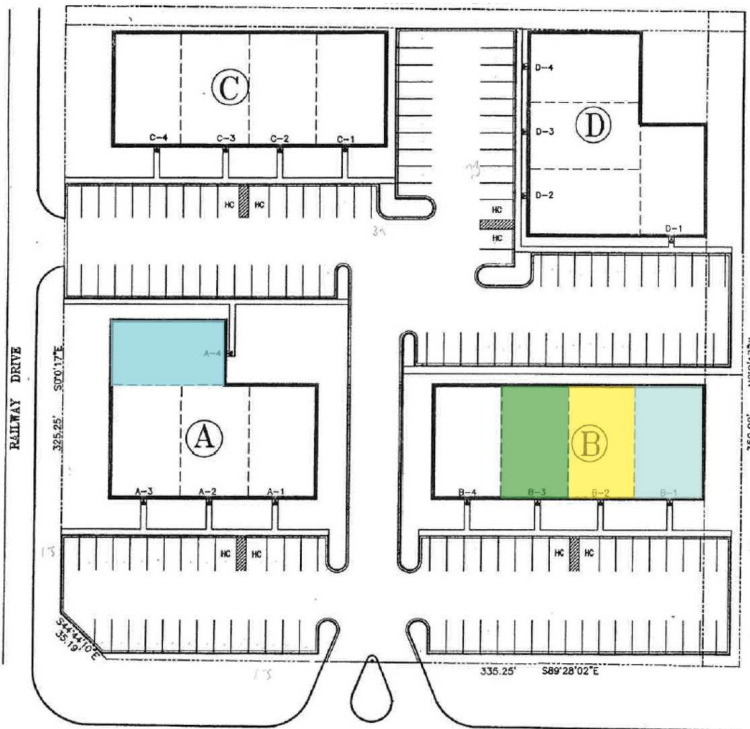
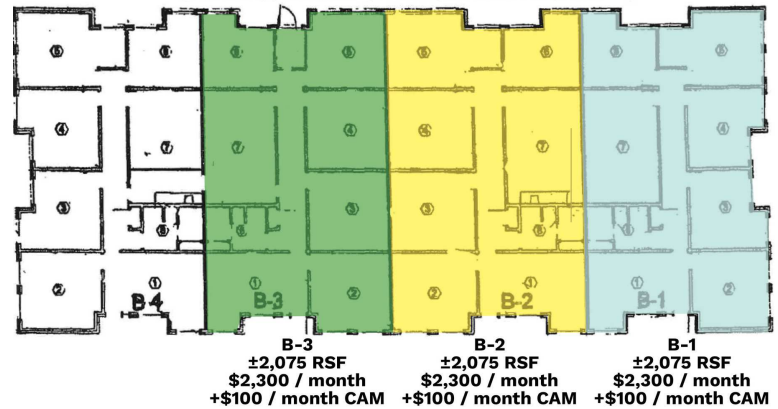

TOM FIELDS

tfields@priceedwards.com

O: 405.239.1205