

7408 NW 83RD

OKLAHOMA CITY, OK 73134



PROPERTY DESCRIPTION

The Rockwell Industrial Park is located in the Northwest quadrant of Oklahoma City. Sitting just north of Wiley Post Airport, this location allows quick access to the Northwest Expressway and in turn, the Kilpatrick Turnpike and all points beyond. Fine and casual dining abound in the area. Big box retailers close by include Target, Lowes along with many other local and national retailers.

CUSTOM HEADER

- FIVE, 2,000 SQUARE FOOT (MOL) ONE (1) UNIT AVAILABLE
- CAN BE LEASED IN 2,000 SQUARE FOOT INCREMENTS
- 12' ON-GRADE OVERHEAD DOORS, 1 PER UNIT
- 250' SQUARE FEET (MOL) CLIMATE CONTROLLED OFFICE
- ADA COMPLIANT RESTROOMS
- FULLY INSULATED WAREHOUSE SEPARATELY METERED UTILITIES

OFFERING SUMMARY

Lease Rate:	\$10.00 SF/yr (NNN)
Number of Units:	1
Available SF:	2,000 SF
Lot Size:	0.55 Acres

C. DEREK JAMES

djames@priceedwards.com

O: 405.239.1206

7408 NW 83RD

OKLAHOMA CITY, OK 73134

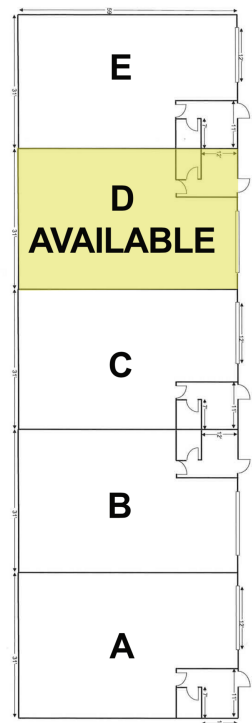

C. DEREK JAMES

djames@priceedwards.com

O: 405.239.1206