

Space for Lease

908 S.E. 29th Street Oklahoma City, OK 73129



OFFERING SUMMARY

Lease Rate:	\$3,000/month NNN
Building Size:	6,800 SF
Available SF:	6,800 SF
Lot Size:	1.5 Acres
Year Built:	1967
Taxes	\$2,092.72

PROPERTY OVERVIEW

Located in OKC's Oil Patch Area, this property offers 665 square feet of office space, 1,335 square feet of showroom space and a 4,800 square foot shop constructed of insulated metal.

SITE DETAILS

Office & Shop Buildings on 2 Acres +/-, Fenced & Graveled Yard, Electronic Gate Opener, Two Underground Storm Shelters

OFFICE AREA DESCRIPTION

7 Private Offices, Conference Room, Men's & Women's Restrooms, Shop Locker Room w/Shower, Phone Room, Storage Area, Break/Lunch Room, Laundry Room, Entry Area

SHOP AREA DESCRIPTION

Three 14' and two 16' Overhead Doors, Floor Drains, Two 5 Ton Cranes, One 2 Ton Crane, Paint Booth, Exhaust Fans

MARK PATTON
405.843.7474
mpatton@priceedwards.com
priceedwards.com

CODY BEAT
405.239.1235
cbeat@priceedwards.com
priceedwards.com

Space for Lease

908 S.E. 29th Street Oklahoma City, OK 73129

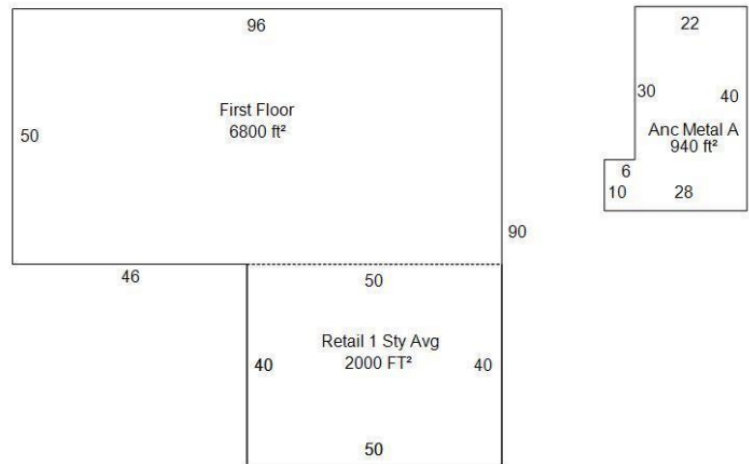

MARK PATTON
405.843.7474
mpatton@priceedwards.com
priceedwards.com

CODY BEAT
405.239.1235
cbeat@priceedwards.com
priceedwards.com