

Danforth Plaza

2000 W. Danforth Rd, Edmond, Ok 73003



RETAIL SPACE NOW AVAILABLE

Lease Rate:	\$13.00 SF (NNN)
Available SF:	1,800 - 2,409 SF
Lot Size:	4.24 Acres
Building Size:	29,962 SF
Year Built:	2004
Zoning:	Neighborhood Commercial (D2)
Market Submarket:	OKC Metro Edmond
Cross Streets:	Danforth & Santa Fe

PROPERTY OVERVIEW

Neighborhood retail center just east of N Santa Fe, adjacent to Walmart, on W. Danforth has banking, fast food, and other retail in the immediate area.

Located in the heart of one of the fastest growing parts of Edmond. Danforth Plaza offer ease of access and great exposure.

Neighbors include: Wal-Mart SuperCenter, Kohl's, LA Fitness, The Meat House, Dollar Tree, CVS, 7-Eleven, At The Beach, Legacy Cleaners and multiple other retailers.

AVAILABLE SPACES:

Suite 116	1,800 SF
Suite 120	2,409 SF

GEORGE WILLIAMS, CCIM
405.239.1270
gwilliams@pricedwards.com
pricedwards.com

Danforth Plaza

2000 W. Danforth Rd, Emond, OK 73003

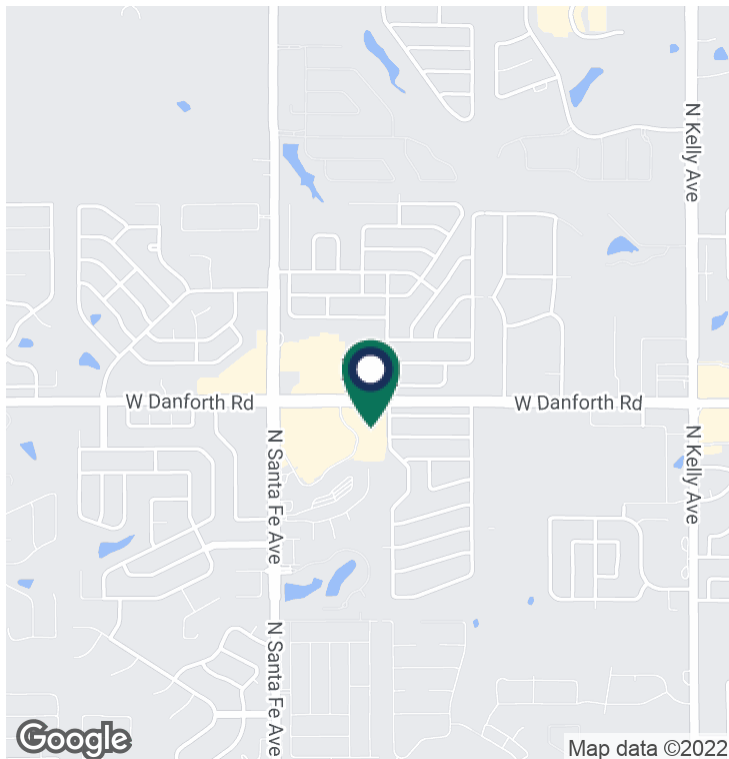
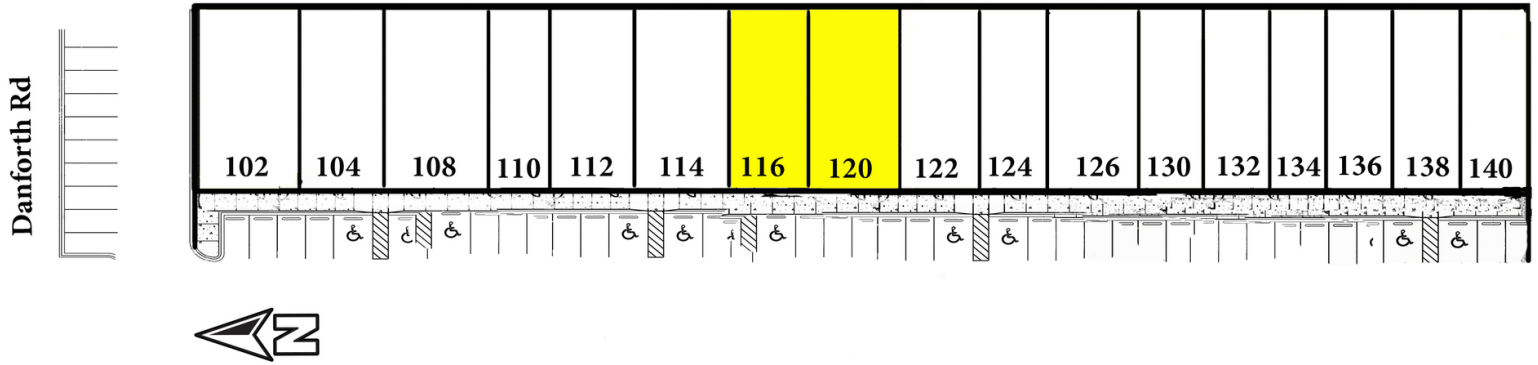

DEMOGRAPHICS (PER 2010 CENSUS; 5 MILES RADIUS)

Total Population	121,710
Population Density	121,710
Median Age	33.4
Median Age (Male)	32.3
Median Age (Female)	34.3
Total Households	46,257
# of Persons Per HH	2.6
Average HH Income	\$90,890
Average House Value	\$229,687

TRAFFIC COUNTS (PER ACOG)

Santa Fe	North	13,396
Santa Fe	South	21,922
W Danforth	East	20,259
W Danforth	West	14,324
		12122022

GEORGE WILLIAMS, CCIM
405.239.1270
gwilliams@pricedwards.com
pricedwards.com