



OFFERING SUMMARY

Lease Rate:	\$15.00 SF/yr (Full Service) with 3% annual increases
Suite 225:	±1,046 RSF
Suite 250:	±2,530 RSF
Year Built:	1915
Year Renovated:	1997
Cross Streets:	Broadway & NW 4th
Market:	CBD

PROPERTY OVERVIEW

The Historic E.K. Gaylord Building is located at the northeast corner of 4th and Broadway in Oklahoma City, providing easy accessibility along with the benefits of downtown. The architecturally significant building is listed on the National Register of Historic Places. The E.K. Gaylord Building offers below market rates in an effort to assist and facilitate the needs of non-profit organizations.

PROPERTY HIGHLIGHTS

- 5-story tower
- Adjacent to the YMCA of Greater OKC and its daycare center
- Cardkey access

TOM FIELDS
405.239.1205
tfields@priceedwards.com
priceedwards.com

CRAIG TUCKER
405.843.7474
ctucker@priceedwards.com
priceedwards.com

E.K. Gaylord Building

500 N Broadway, Oklahoma City, OK 73102

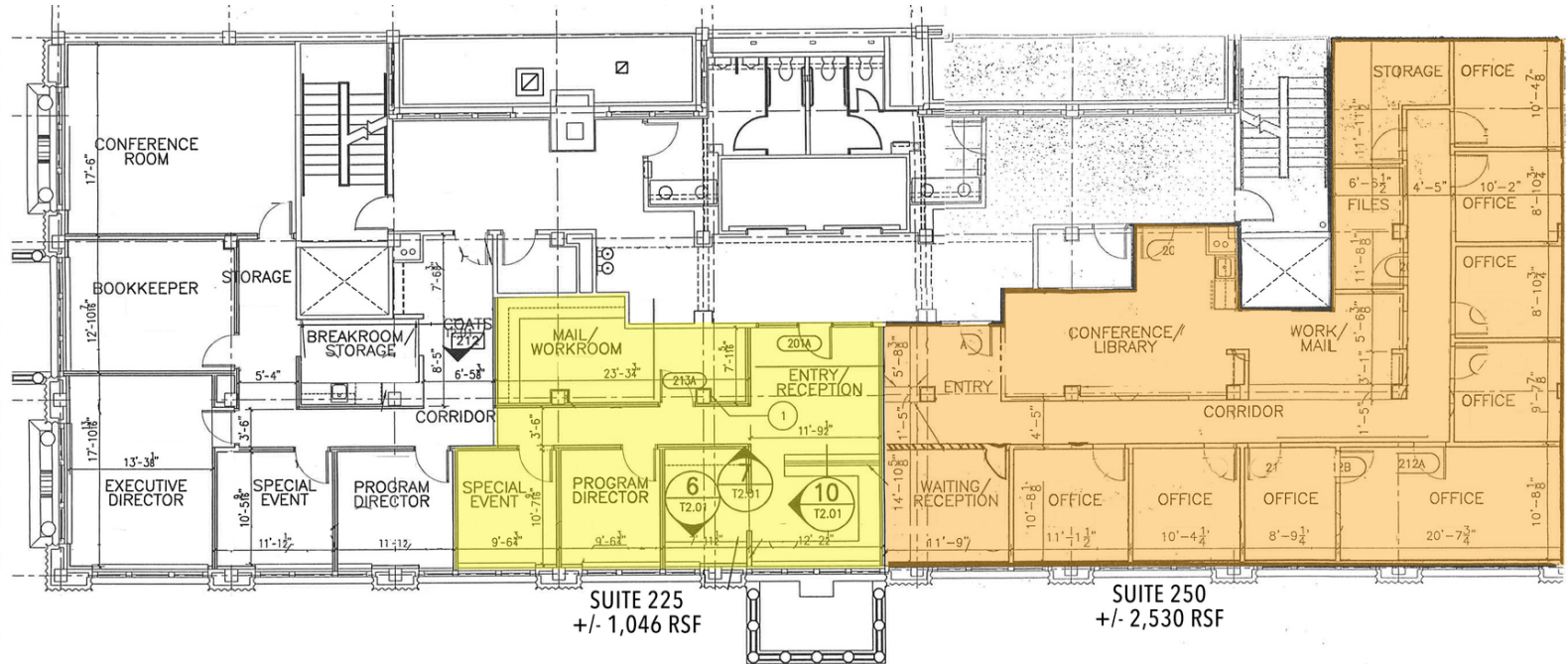

TOM FIELDS
405.239.1205
tfields@priceedwards.com
priceedwards.com

CRAIG TUCKER
405.843.7474
ctucker@priceedwards.com
priceedwards.com