

PRIME RETAIL SPACE ADJACENT TO KOHL'S

Oklahoma City, OK 73132 | 9001 NW Passage | NW Expressway between Council Rd & Rockwell Ave | #488 | NW Oklahoma City



- 24,600 +/- sf space available adjacent to Kohl's.
- Located on NW Expressway, between N Council Rd & N Rockwell Ave located in Silver Springs Pointe Shopping Center with Walmart Supercenter, Office Depot and Sam's Club.

DEMOGRAPHICS	1 MILE	3 MILES	5 MILES	TRAFFIC COUNTS		
2018 POPULATION	11,544	71,176	155,307	NW Expressway	east	37,290
2018 AVERAGE HH INCOME	\$ 70,052	\$ 81,133	\$ 80,917	NW Expressway	west	27,697
2018 MEDIAN HH INCOME	\$ 56,577	\$ 63,769	\$ 59,969	N Council Rd	South	17,560

AVAILABLE SF:
24,600 SF
 FRONTAGE:
APPROXIMATELY 97'6"
 ZONING:
COMMERCIAL
 RATES:
CALL FOR DETAILS

AREA ANCHORS



FOR MORE INFORMATION, CONTACT EXCLUSIVE ASSOCIATE:
 KARLEEN KRYWUCKI . kkrywucki@pricedwards.com . 405.239.1243

Demographics ESRI 2018 No warranty expressed or implied has been made as to the accuracy of the information provided herein, no liability assumed for error or omissions.



PRIME RETAIL SPACE ADJACENT TO KOHL'S

Oklahoma City, OK 73132 | 9001 NW Passage | NW Expressway between Council Rd & Rockwell Ave | #488 | NW Oklahoma City



FOR MORE INFORMATION, CONTACT EXCLUSIVE ASSOCIATE:
 KARLEEN KRYWUCKI . kkrywucki@pricedwards.com . 405.239.1243



Demographics ESRI 2018 No warranty expressed or implied has been made as to the accuracy of the information provided herein, no liability assumed for error or omissions.

PRIME RETAIL SPACE ADJACENT TO KOHL'S

Oklahoma City, OK 73132 | 9001 NW Passage | NW Expressway between Council Rd & Rockwell Ave | #488 | NW Oklahoma City

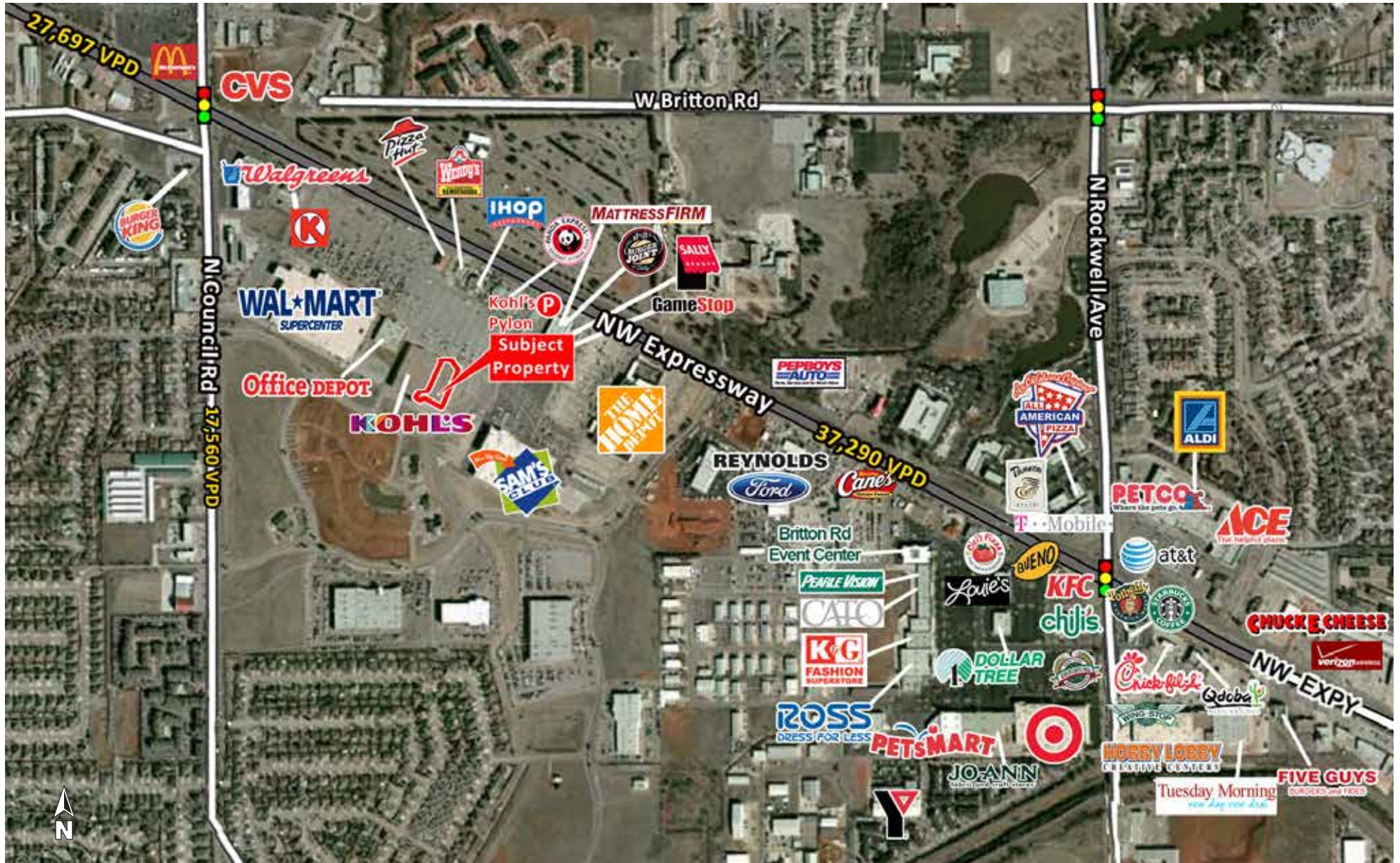

PRICE EDWARDS
AND COMPANY

FOR MORE INFORMATION, CONTACT EXCLUSIVE ASSOCIATE:
KARLEEN KRYWUCKI . kkrywucki@priceedwards.com . 405.239.1243

Stan Johnson Co.
THE NET LEASE AUTHORITY™

CHAINLINKS
RETAIL ADVISORS

Demographics ESRI 2018 No warranty expressed or implied has been made as to the accuracy of the information provided herein, no liability assumed for error or omissions.

PRIME RETAIL SPACE ADJACENT TO KOHL'S

Oklahoma City, OK 73132 | 9001 NW Passage | NW Expressway between Council Rd & Rockwell Ave | #488 | NW Oklahoma City

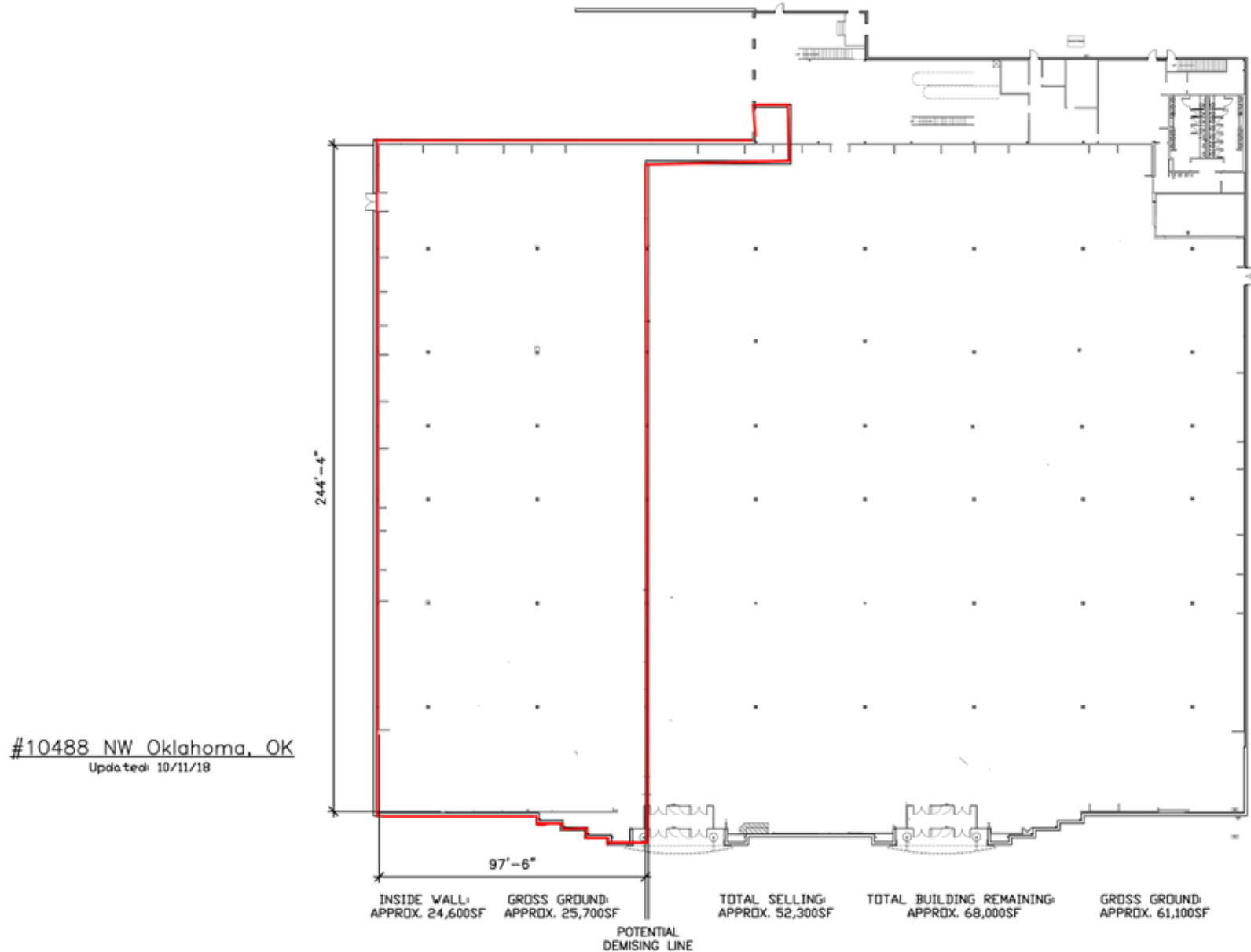

PRICE EDWARDS
AND COMPANY

FOR MORE INFORMATION, CONTACT EXCLUSIVE ASSOCIATE:
KARLEEN KRYWUCKI . kkrywucki@pricedwards.com . 405.239.1243

 **Stan Johnson Co.**
THE NET LEASE AUTHORITY®

CHAINLINKS
RETAIL ADVISORS

Demographics ESRI 2018 No warranty expressed or implied has been made as to the accuracy of the information provided herein, no liability assumed for error or omissions.