

THE STEELYARD

Retail Suites Available For Lease



OFFERING SUMMARY

Available SF:	1,000 - 4,101 SF
Lease Rate:	\$23.00 SF/yr MG
Use:	Restaurant, Retail, Services, Creative Office
Building Size:	10,809
Market:	Downtown
Submarket:	Bricktown

ABOUT THE STEELYARD

The Steelyard is Bricktown's newest mixed-use development. The project includes 250 apartments, two hotels (AC by Marriott and Hyatt Place) and 12,000+ SF of retail.

Property is located on Sheridan Avenue, a well-traveled entrance to both Bricktown and the Central Business District. Ample sign opportunities are available for retail tenants. Retail suites can be combined.

RETAIL HIGHLIGHTS

- High ceilings
- Clean, industrial aesthetic
- 300+ residents on site
- Walkable to the Criterion, numerous hotels, Bricktown attractions and the Deep Deuce neighborhood.
- Located on a streetcar stop, which provides access to Automobile Alley, Midtown, Central Business District, Scissortail Park and the Convention Center.

ALLISON BARTA BAILEY

Price Edwards - Urban
abailey@priceedwards.com
405.239.1245
210 Park Ave, Suite 700, Oklahoma City, OK 73102
priceedwards.com

THE STEELYARD

505 E. Sheridan Avenue Oklahoma City, OK 73104



LEASE TYPE | MG

SIZES AVAILABLE | 1,000 - 4,100 SF

LEASE TERM | Negotiable

LEASE RATE | \$23.00 SF/yr

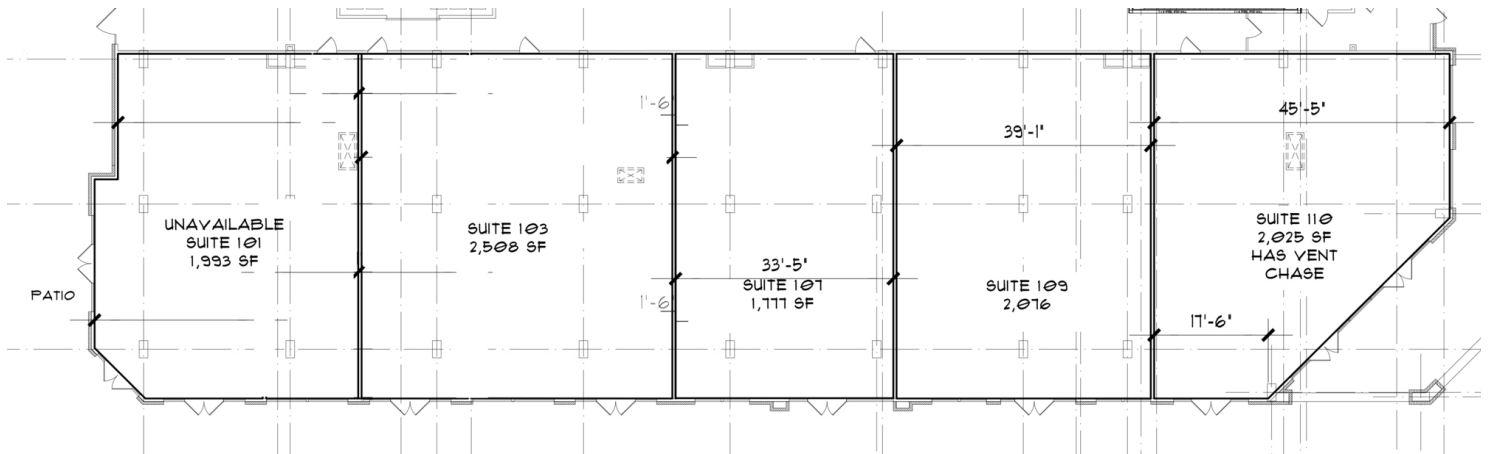

SUITE	SIZE (SF)	LEASE RATE	DESCRIPTION
Suite 103	2,508 SF	\$23.00 SF/yr	1st floor retail facing E. Sheridan Avenue
Suite 107	1,777 SF	\$23.00 SF/yr	1st floor retail facing E. Sheridan Avenue
Suite 109	2,076 SF	\$23.00 SF/yr	1st floor retail facing E. Sheridan Avenue
Suite 110	2,025 SF	\$23.00 SF/yr	1st floor retail facing E. Sheridan Avenue with patio space on Steelyard Drive
Steelyard Drive, Suite 113	2,000 SF	\$23.00 SF/yr	Retail/Office/Flex space facing The Yard, located in east building

ALLISON BARTA BAILEY

Price Edwards - Urban

abailey@priceedwards.com

405.239.1245

210 Park Ave, Suite 700, Oklahoma City, OK 73102

priceedwards.com