



OFFERING SUMMARY

Sale Price: \$725,000

Building Size: 12,000 SF

Acres: 2.24 Acres

Price / SF: \$60.42

Year Built: 1986

LOCATION OVERVIEW

Located on the north side of SE 29th Street just west of Eastern Avenue.

PROPERTY HIGHLIGHTS

- Building height: 16'
- 2 drive ins: both are 10' wide x 12' high
- 15 parking spots
- 1 dock door
- 8 individual offices
- Break room
- Reception area
- 2 office restrooms
- 1 warehouse restroom

CHRIS ROBERTS
405.239.1236
croberts@priceedwards.com
priceedwards.com

Industrial Building For Sale

1901 SE 29th St., Oklahoma City, OK 73129

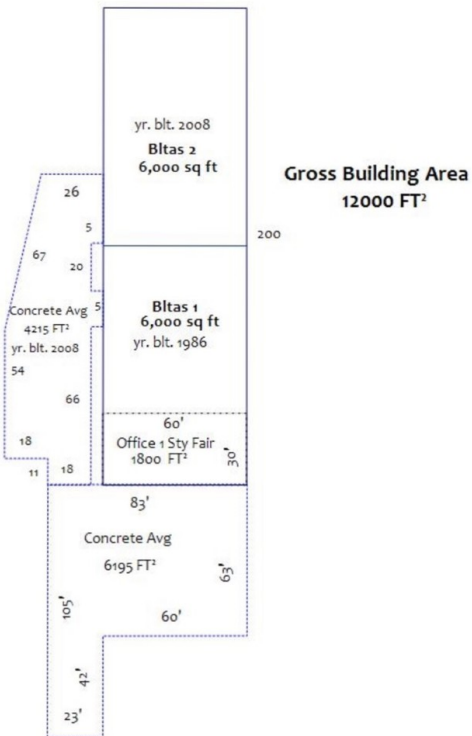

CHRIS ROBERTS
405.239.1236
croberts@priceedwards.com
priceedwards.com