

25 Acres For Sale - Moore, Oklahoma

North of N.W. 27th & I-35, Moore, OK 73160



LAND SPACE NOW AVAILABLE

Sale Price:	\$6,534,000
Lot Size:	25.0 Acres
Price Per SQ FT:	\$6.00

PROPERTY OVERVIEW

- 25 +/- acres of development land with I-35 frontage in the Moore city limits. For a suitable development Moore will extend water and waste water utilities to the site.
- Seller has a Phase II environmental for 20 acres of adjacent land with the same original use which found no actionable contaminants.
- I-35 traffic count 126,000 vehicles per day.

LOCATION OVERVIEW

Located on the east side of I-35 north of N.W. 27th in Moore, Oklahoma.

CHRIS ROBERTS
405.239.1236
croberts@pricedwards.com
pricedwards.com

25 Acres For Sale - Moore, Oklahoma

North of N.W. 27th & I-35, Moore, OK 73160

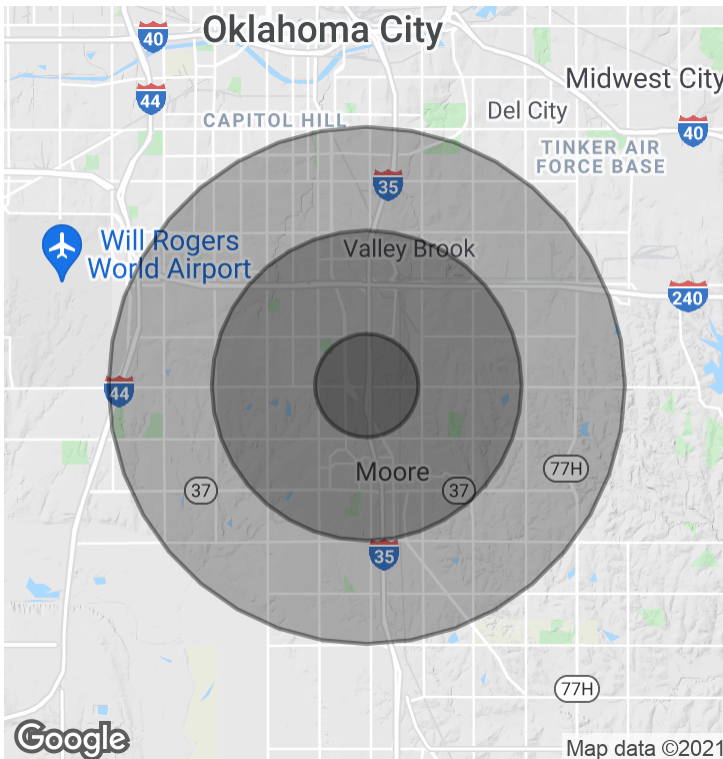
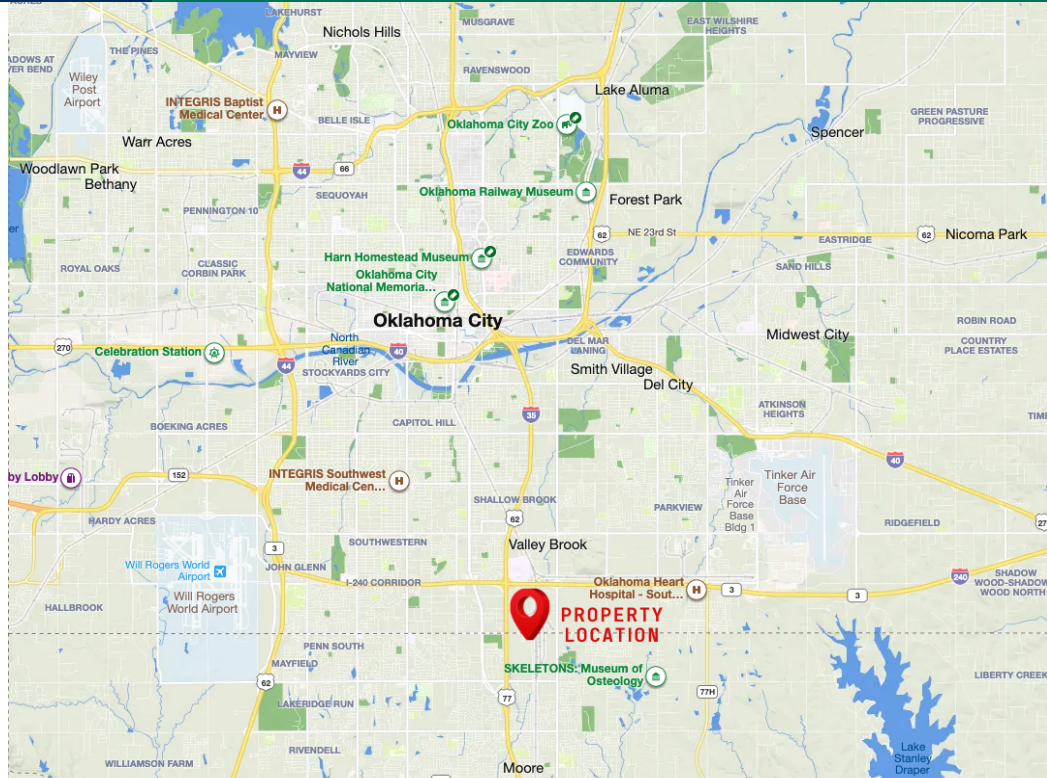

DEMOGRAPHICS (PER 2010 CENSUS; 5 MILES RADIUS)

Total Population	198,501
Population Density	198,501
Median Age	33.4
Median Age (Male)	32.6
Median Age (Female)	34.3
Total Households	74,925
# of Persons Per HH	2.6
Average HH Income	\$56,900
Average House Value	\$129,268

TRAFFIC COUNTS (PER ACOG)

Address	Direction	#
---------	-----------	---

CHRIS ROBERTS
405.239.1236
croberts@priceedwards.com
priceedwards.com