

510 EAST MEMORIAL ROAD

OKLAHOMA CITY, OK 73114



LOCATION DESCRIPTION

Located a half of a mile west of the Broadway Extension off of Memorial Road.

PROPERTY HIGHLIGHTS

- Tenant pays utilities direct to provider plus tenants share water/sewer/trash
- This beautiful garden office property consists of 4 buildings totaling about 32,000 SF
- Abundant parking adjacent to the office
- Restaurants within walking distance
- Tenant controls heat & air conditioning
- Landlord responsible for maintenance

OFFERING SUMMARY

Building A-4:	±2,075 RSF \$2,300 / month + \$100 / month CAM
Building B-2:	±2,075 RSF \$2,300 / month + \$100 / month CAM
Building B-3:	±2,075 RSF \$2,300 / month + \$100 / month CAM
*Both B spaces can be combined for ±4,150 RSF	

TOM FIELDS

tfields@priceedwards.com
O: 405.239.1205

510 EAST MEMORIAL ROAD

OKLAHOMA CITY, OK 73114

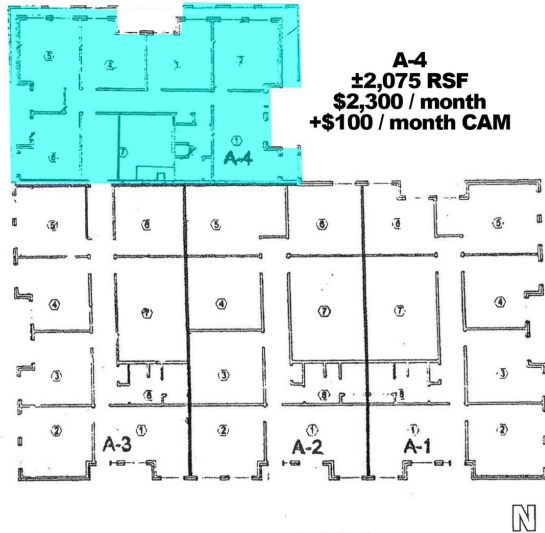

Both spaces can be combined for ±4,150 RSF

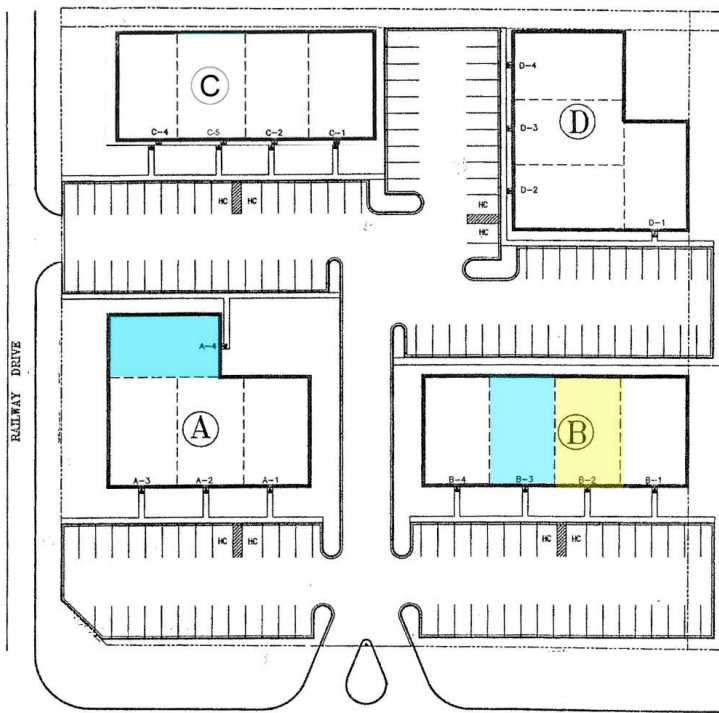
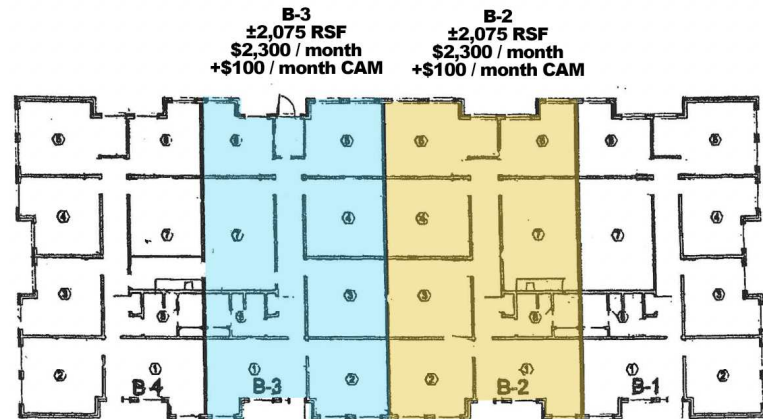

TOM FIELDS

tfields@priceedwards.com

O: 405.239.1205