

ATRIUM TOWERS (NORTH) FOR LEASE 2nd Floor



OFFICE SPACE NOW AVAILABLE

Available SF:

±13,324 RSF
Floors 2-3 can be combined for
±19,300 RSF

Lease Rate:

Starting at \$18.50/RSF
with 3% annual increases

Building Size:

78,308 SF

Building Class:

B

Building Profile:

Atrium Tower (north) is a 6-story building with a beautiful atrium allowing natural light throughout the entire building

PROPERTY OVERVIEW

AMENITIES:

- Ample free parking
- Atrium allows natural light to interior offices
- Numerous restaurants, banks & shopping nearby
- Upper floors offer view of Lake Hefner
- Superb visibility from Lake Hefner Parkway
- Traffic light provides easy ingress and egress
- Space includes like new furniture throughout for an additional cost
- Views of Lake Hefner

LOCATION OVERVIEW

Conveniently located at NW 63rd and Lake Hefner Parkway

TOM FIELDS

405.239.1205

tfields@priceedwards.com

priceedwards.com

CRAIG TUCKER

405.843.7474

ctucker@priceedwards.com

priceedwards.com

2nd Floor
13,324 RSF

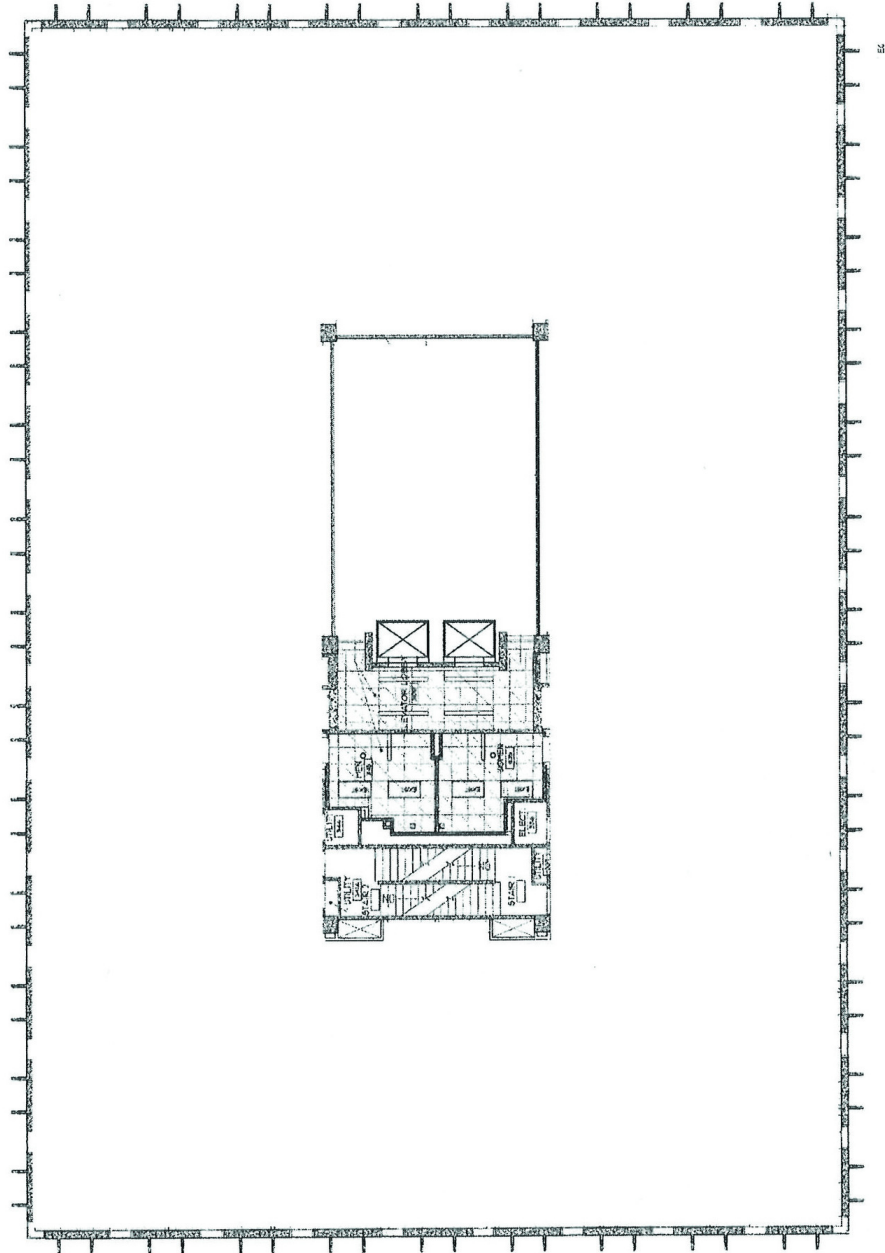

TOM FIELDS
405.239.1205
tfields@priceedwards.com
priceedwards.com

CRAIG TUCKER
405.843.7474
ctucker@priceedwards.com
priceedwards.com