

FISHER HALL - 3540 S. BOULEVARD

EDMOND, OK 73013



LOCATION DESCRIPTION

Fisher Hall is well located in a tremendous area of growth in the popular suburb of Edmond, Oklahoma. The area is becoming increasingly popular with office users due to its proximity to upper and middle management personnel as well as its accessibility to Oklahoma City. Its location is well served from the east and west by the Kilpatrick Turnpike and Memorial Road and from the south by Eastern Avenue and Broadway Extension just one mile to the west.

PROPERTY HIGHLIGHTS

- Beautiful Class A Building
- Overlooks a small lake
- Free on-site parking

OFFERING SUMMARY

Suite 100:	±3,188 RSF
Suite 155:	±1,618 RSF
Suite 200:	±3,289 RSF
Suite 250:	±2,414 RSF
Suite 275:	±3,948 RSF
Suite 280:	±1,840 RSF
Lease Rate:	\$21.00 SF/yr (Full Service) with 3% annual increases
Building Size:	60,441 SF
Year Built:	2006
Market:	Edmond

TOM FIELDS

tfields@priceedwards.com
O: 405.239.1205

CRAIG TUCKER

ctucker@priceedwards.com
O: 405.239.1202 C: 405.641.3218

FISHER HALL - 3540 S. BOULEVARD

EDMOND, OK 73013

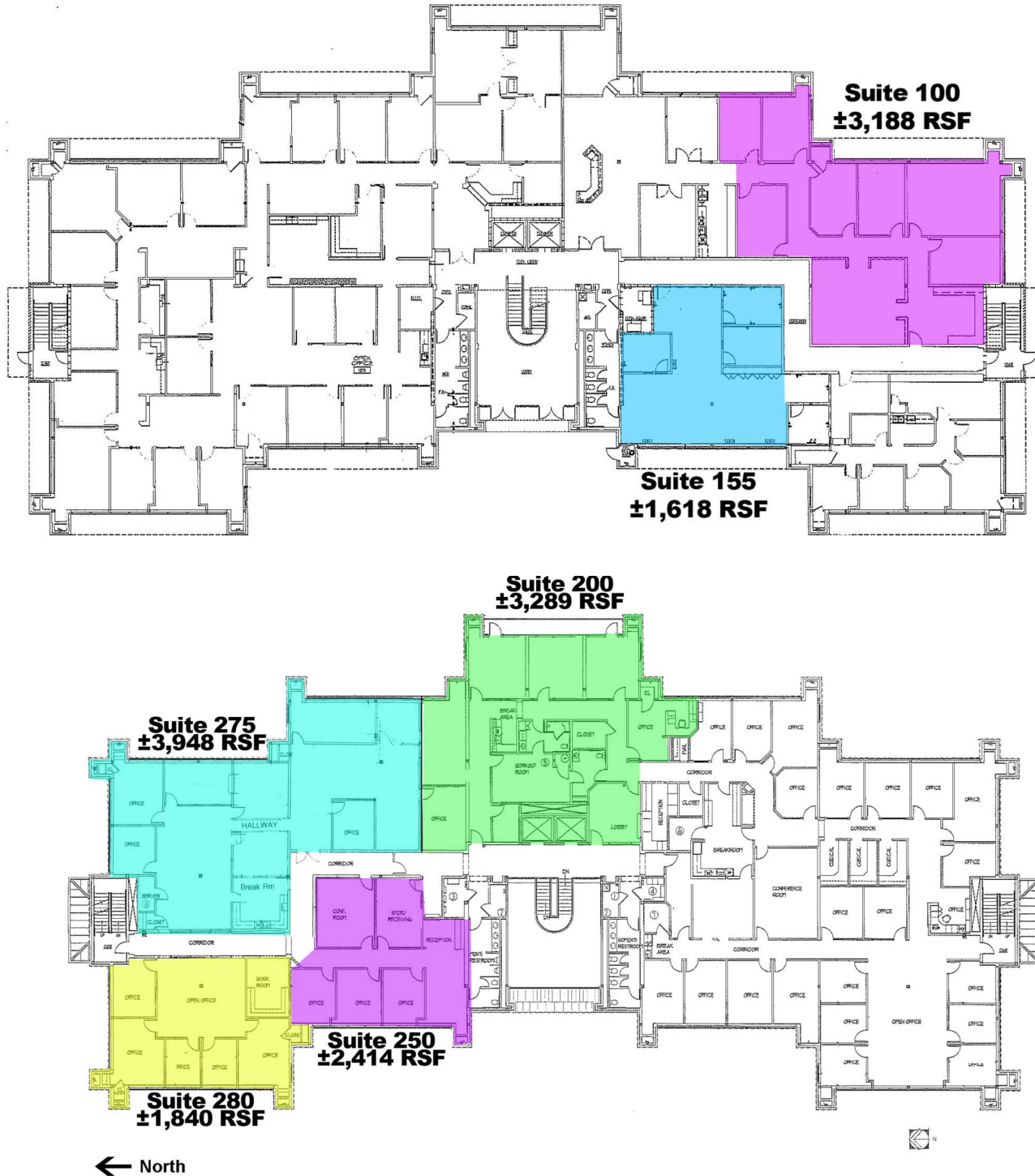

TOM FIELDS

tfields@priceedwards.com

O: 405.239.1205

CRAIG TUCKER

ctucker@priceedwards.com

O: 405.239.1202 C: 405.641.3218